



2018-19 Manufacturer's Suggested Retail Price List



All prices in Canadian currency.
Effective October 1, 2018.
Prices charged by dealer or retailer may vary from manufacturer's suggested retail prices.

WILGER Visual Ball Flow Indicators Fittings & Accessories



Page 13-14

NEW COMBO-JET® UR SERIES

COMBO-JET®

Page 3-6

ER/SR/MR/DR & UR SERIES SPRAY TIPS



FINER
SPRAY

5 series of Spray Tips for a Sliding Scale of Droplet Size

BEST DRIFT
REDUCTION

NEW PRODUCT

WILGER Electronic Flow Monitoring System Row-by-Row Flow Monitoring



Shows flow rate and blockage monitor in the cab
for up to 3 products or 196 rows

Page 15

COMBO-JET®

Nozzle Bodies & Accessories



Wet & Dry
Boom Nozzle
Bodies

Wet
Boom
Page 7

Dry
Boom
Page 10

COMBO-RATE® Stacking Nozzle Bodies



NEW
COMBO-RATE®
Side Take-Off Turret

Page 8-9

NEW

O-Ring Seal (ORS) Manifolds, Metering Orifices & Check Valve Bodies

Liquid manifolds for accurate application



ORS Manifolds

Page 14

BOOM END FLUSH VALVES

Compact, Quarter-turn
Boom Flush Valve



Page 10

QUICK-NUT SST

Stainless Booms
& Components

1/2" & 1" Booms
& Fittings



Page 10-11

The Combo-Jet® Spray Tip Advantage

The most versatile spray tips for Pulse Width Modulation Systems
(e.g. Capstan Pinpoint®, Case AIMCommand®, Raven Hawkeye®, John Deere ExactApply® & more)

40% Longer Strainer that snaps & seals into place

SR / MR / DR / UR Drift Reduction Series

ISO cap color matches flow rate

Longer lasting & permanent stainless steel spray tip

Spray tip & cap handles as one piece

Easy to read cap label
(MR110-06 = MR Series, 110° tip, 0.6 USGPM flow rate)

Droplet Size Information & Charts For Best Information to Select Best Spray Tip

Fits nozzle bodies for most sprayers, with adapters to fit all other sprayers

Easy spray tip cleaning & maintenance

SR, MR, DR & UR Series

To clean stainless tip
Pull strainer (with pre-orifice) up and out

To clean plastic pre-orifice
Push strainer sideways to release from pre-orifice

ER Series
Push strainer sideways to remove

To use/replace strainer
Push strainer down to snap in strainer

WILGER.NET has some of the most useful spray tip selection tools in the world. Check them out!

FREE

TIP WIZARD

FREE SMARTPHONE APP

www.wilger.net

TIP WIZARD ONLINE

No Internet? No Problem.

www.WILGER.NET

Credit Card Style USB Stick

EXCEL-BASED CHARTS

GOOD OLD TIP CHARTS

Differences between the five COMBO-JET® Spray Tip Series

! All COMBO-JET® spray tips within the same flow rate/size are completely interchangeable to change levels of coverage and drift reduction. The coarser drift reduction series (SR/MR/DR/UR) share the same tip angles to ensure consistent spray patterns for even coverage, regardless of series used.



Comparison Criteria	ER Series Extended Range	SR Series Small Reduction	MR Series Mid-Range Reduction	DR Series Drift Reduction	UR Series Drift Reduction
Tip-Cap Design	Conventional Flat Fan	Pre-orifice Drift Reduction	Pre-orifice Drift Reduction	Pre-orifice Drift Reduction	Dual Chamber Drift Red.
Droplet Size ¹ @40PSI	Smallest (246µ VMD ¹)	Medium (371µ VMD ¹)	Large (474µ VMD ¹)	Very Large (529µ VMD ¹)	Ultra Coarse
% <141µ ² % <600µ ³	20% of volume < 141µ 94% of volume <600µ	8% of volume < 141µ 89% of volume <600µ	4% of volume < 141µ 74% of volume <600µ	2% of volume < 141µ 64% of volume <600µ	UR spray tips are specialty spray tips, designed for certain chemical applications that require exceptional drift reduction. They are not to be replaced with other spray tip series that are not approved to be on the chemical label. Always follow up-to-date label information.
Drift Potential	Most likely to drift	Lower drift potential	Major reduction	Least likely to drift	Refer to chemical application label for maximum pressures, speeds and application information.
Coverage	Best	Excellent	Very good	Good	More information available at www.wilger.net

¹Based on an XX110-06 nozzle @ 40 psi (2.75 BAR)

²Droplets smaller than 141µ are more likely to drift. 141µ is used as a standard for determining driftable fines.

³Droplets smaller than 600µ provide better coverage. Droplets > 600µ consume more spray volume, reducing overall coverage.

For complete Terms and Conditions, visit www.wilger.net.

Wilger products are sold exclusively to original equipment manufacturers and authorized distributors, and are available to the end user through their retail dealerships. Prices shown are manufacturer suggested retail prices. Dealer selling prices may vary.

Warranties - Wilger warrants that its products are free of defects in material and workmanship and perform to each product's specifications. The foregoing warranties are in lieu of all other warranties, written or expressed, including, but not limited to, those concerning suitability for a particular purpose. Claims under these warranties must be made promptly within one (1) year after receipt of goods by the buyer. Any warranty action by the buyer must be expressly pre-authorized by Wilger.

Limitation of Liabilities - Except for claims for bodily injury, Wilger's liability for any and all claims arising out of the purchase of the product shall not exceed the billed or billable value of the product. In no case will Wilger be liable for any consequential damages or loss of profit, even if Wilger has been advised of the possibility of such damages.

Technical Assistance - Wilger personnel are available to provide technical assistance in the choice and use of products furnished to the buyer and will do so free of charge. Wilger assumes no obligation or liability for any such advice, or any consequences occurring as a result of the application of such advice. The buyer is solely responsible for the selection of the appropriate product(s) and the appropriate application to the intended end use.

Combo-Jet® 80° Spray Tips

For full detailed application information, visit www.wilger.net.
Premium VITON™ options available: change part# to XXXX-VXXX
e.g. [Standard] 40280-015 // [VITON™] 40280-V015. See note* for VITON™ upcharge.

NOTE: For the full chart of pressures, speeds and droplet size, refer to Tip Wizard or the Combo-Jet® Spray Tip Brochure.
Strainer Recommendations: For tip sizes up to -.015, 100 Mesh Strainer (#40251-00). For spray tip sizes -.02 to -.06, 50 Mesh Strainer (#40250-00).

Tip Cap Size	Flow Rate USGPM	PSI	Application Rate - US Gallons/Acre @ 20"								Spray Classification, VMD (in µ); % <141µ (% Drift. Fines); % <600µ (% of small droplets)												Tip-Cap, Part # & MSRP								
			Sprayer Speed - Miles/Hour								ER 80° Series				SR 80° Series				MR 80° Series				DR 80° Series				Description	Part #	MSRP		
			5	7.5	10	12.5	15	17.5	20	Cat	VMD	<141	<600	Cat	VMD	<141	<600	Cat	VMD	<141	<600	Cat	VMD	<141	<600						
005	0.043	30	2.6	1.7	1.3	 <p>TIP WIZARD Reminder: Full pressure & speed specifications for any nozzle spacing is available on Tip Wizard.</p>				F	149	41%	100%	-	-	-	-	M	236	17%	100%	C	276	11%	100%	ER80-005	40270-005	\$14.94			
	0.050	40	3.0	2.0	1.5					F	137	55%	100%	-	-	-	-	F	201	26%	100%	M	230	19%	100%	-	-	-	-	-	-
	0.056	50	3.3	2.2	1.7					F	128	63%	100%	-	-	-	-	F	178	33%	100%	F	200	25%	100%	MR80-005	40290-005	\$22.04			
	0.061	60	3.6	2.4	1.8					F	121	68%	100%	-	-	-	-	F	161	39%	100%	F	178	31%	100%	DR80-005	40280-005	\$17.16			
0067	0.058	30	3.4	2.3	1.7	F	180	35%	100%	-	-	-	-	F	211	24%	100%	C	308	9%	100%	ER80-0067	40270-007	\$14.94							
	0.067	40	4.0	2.6	2.0	F	153	45%	100%	-	-	-	-	F	182	33%	100%	M	267	13%	100%	-	-	-	-	-	-				
	0.075	50	4.4	3.0	2.2	F	141	52%	100%	-	-	-	-	F	162	40%	100%	M	239	17%	100%	MR80-0067	40290-007	\$17.16							
	0.082	60	4.9	3.2	2.4	F	131	58%	100%	-	-	-	-	F	148	46%	100%	M	218	20%	100%	DR80-0067	40280-007	\$17.16							
01	0.09	30	5.1	3.4	2.6	2.1	1.7	1.5	1.3	F	156	41%	100%	M	233	21%	97%	M	218	23%	97%	C	312	10%	94%	ER80-01	40270-01	\$8.70			
	0.10	40	5.9	4.0	3.0	2.4	2.0	1.7	1.5	F	143	49%	100%	F	199	29%	97%	F	191	30%	97%	C	274	14%	96%	SR80-01	40288-01	\$14.94			
	0.11	50	6.6	4.4	3.3	2.7	2.2	1.9	1.7	F	134	56%	100%	F	176	36%	98%	F	173	36%	97%	M	248	17%	98%	MR80-01	40290-01	\$14.94			
	0.12	60	7.3	4.8	3.6	2.9	2.4	2.1	1.8	F	128	62%	100%	F	159	41%	98%	F	159	40%	97%	M	229	19%	99%	DR80-01	40280-01	\$14.94			
015	0.13	30	7.7	5.1	3.9	3.1	2.6	2.2	1.9	F	180	29%	100%	M	262	16%	95%	C	323	10%	94%	VC	418	4%	87%	ER80-015	40270-015	\$8.70			
	0.15	40	8.9	5.9	4.5	3.6	3.0	2.5	2.2	F	167	34%	100%	M	230	22%	96%	C	283	14%	96%	C	380	6%	90%	SR80-015	40288-015	\$14.94			
	0.17	50	10.0	6.6	5.0	4.0	3.3	2.8	2.5	F	158	39%	100%	F	207	26%	97%	M	256	17%	97%	C	353	7%	92%	MR80-015	40290-015	\$14.94			
	0.18	60	10.9	7.3	5.5	4.4	3.6	3.1	2.7	F	151	42%	100%	F	191	30%	97%	M	236	20%	98%	C	332	8%	94%	DR80-015	40280-015	\$14.94			
02	0.17	30	10.3	6.9	5.1	4.1	3.4	2.9	2.6	F	170	34%	100%	M	257	16%	95%	C	326	8%	94%	XC	454	3%	80%	ER80-02	40270-02	\$8.70			
	0.20	40	11.9	7.9	5.9	4.8	4.0	3.4	3.0	F	161	38%	100%	M	233	20%	96%	C	298	11%	94%	VC	419	4%	84%	SR80-02	40288-02	\$14.94			
	0.22	50	13.3	8.9	6.6	5.3	4.4	3.8	3.3	F	155	42%	100%	M	216	24%	97%	C	277	14%	95%	VC	394	5%	87%	MR80-02	40290-02	\$14.94			
	0.24	60	14.5	9.7	7.3	5.8	4.8	4.2	3.6	F	150	45%	100%	F	203	27%	98%	M	262	16%	95%	C	375	6%	88%	DR80-02	40280-02	\$14.94			
025	0.22	30	12.9	8.6	6.4	5.1	4.3	3.7	3.2	F	209	23%	100%	C	296	11%	93%	VC	425	5%	81%	XC	460	3%	77%	ER80-025	40270-025	\$8.70			
	0.25	40	14.9	9.9	7.4	5.9	5.0	4.2	3.7	F	194	28%	100%	M	268	15%	94%	C	382	6%	85%	VC	430	4%	81%	SR80-025	40288-025	\$14.94			
	0.28	50	16.6	11.1	8.3	6.6	5.5	4.7	4.2	F	182	31%	100%	M	248	18%	95%	C	353	8%	87%	VC	408	5%	83%	MR80-025	40290-025	\$14.94			
	0.31	60	18.2	12.1	9.1	7.3	6.1	5.2	4.5	F	174	34%	100%	M	233	20%	96%	C	330	9%	89%	C	391	6%	85%	DR80-025	40280-025	\$14.94			
03	0.26	30	15.4	10.3	7.7	6.2	5.1	4.4	3.9	F	228	23%	99%	C	344	9%	89%	VC	432	5%	81%	XC	481	3%	72%	ER80-03	40270-03	\$8.70			
	0.30	40	17.8	11.9	8.9	7.1	5.9	5.1	4.5	F	215	26%	99%	C	309	12%	91%	C	390	7%	85%	VC	447	4%	77%	SR80-03	40288-03	\$14.94			
	0.34	50	19.9	13.3	10.0	8.0	6.6	5.7	5.0	F	205	29%	99%	C	285	15%	92%	C	360	8%	88%	VC	422	5%	80%	MR80-03	40290-03	\$14.94			
	0.37	60	21.8	14.5	10.9	8.7	7.3	6.2	5.5	F	197	32%	99%	M	266	17%	93%	C	337	9%	89%	C	403	6%	83%	DR80-03	40280-03	\$14.94			
04	0.35	30	20.6	13.7	10.3	8.2	6.9	5.9	5.1	M	230	21%	99%	C	344	7%	87%	VC	420	5%	80%	XC	543	2%	62%	ER80-04	40270-04	\$8.70			
	0.40	40	23.8	15.8	11.9	9.5	7.9	6.8	5.9	M	216	24%	99%	C	310	10%	89%	C	385	7%	84%	XC	507	3%	68%	SR80-04	40288-04	\$14.94			
	0.45	50	26.6	17.7	13.3	10.6	8.9	7.6	6.6	F	206	26%	99%	C	286	12%	91%	C	360	9%	86%	XC	480	4%	72%	MR80-04	40290-04	\$14.94			
	0.49	60	29.1	19.4	14.5	11.6	9.7	8.3	7.3	F	198	28%	99%	M	267	14%	92%	C	341	10%	88%	XC	460	4%	75%	DR80-04	40280-04	\$14.94			
05	0.43	30	25.7	17.1	12.9	10.3	8.6	7.3	6.4	M	267	16%	95%	C	381	7%	83%	XC	504	3%	68%	XC	574	2%	56%	ER80-05	40270-05	\$8.70			
	0.50	40	29.7	19.8	14.9	11.9	9.9	8.5	7.4	M	248	20%	95%	C	342	10%	86%	VC	466	4%	73%	XC	538	2%	62%	SR80-05	40288-05	\$14.94			
	0.56	50	33.2	22.1	16.6	13.3	11.1	9.5	8.3	M	235	22%	95%	C	314	12%	87%	VC	438	5%	77%	XC	512	3%	67%	MR80-05	40290-05	\$14.94			
	0.61	60	36.4	24.2	18.2	14.5	12.1	10.4	9.1	M	224	25%	95%	C	293	14%	89%	VC	417	6%	79%	XC	492	3%	70%	DR80-05	40280-05	\$17.16			
06	0.52	30	30.9	20.6	15.4	12.3	10.3	8.8	7.7	C	296	17%	91%	VC	420	5%	81%	XC	526	2%	64%	XC	596	1%	51%	ER80-06	40270-06	\$8.70			
	0.60	40	35.6	23.8	17.8	14.3	11.9	10.2	8.9	C	279	20%	91%	C	390	7%	84%	XC	492	3%	70%	XC	564	2%	57%	SR80-06	40288-06	\$14.94			
	0.67	50	39.8	26.6	19.9	15.9	13.3	11.4	10.0	C	267	22%	90%	C	368	8%	86%	VC	468	4%	73%	XC	540	2%	61%	MR80-06	40290-06	\$17.16			
	0.73	60	43.6	29.1	21.8	17.5	14.5	12.5	10.9	M	257	24%	90%	C	351	9%	88%	VC	448	5%	76%	XC	521	3%	64%	DR80-06	40280-06	\$17.16			
08	0.69	30	41.2	27.4	20.6	16.5	13.7	11.8	10.3	F	317	17%	90%	C	490	8%	59%	UC	540	6%	63%	UC	619	3%	52%	ER80-08	40270-08	\$8.70			
	0.80	40	47.5	31.7	23.8	19.0	15.8	13.6	11.9	F	286	21%	93%	C	449	9%	66%	UC	500	8%	69%	UC	585	4%	58%	SR80-08	40288-08	\$17.16			
	0.89	50	53.1	35.4	26.6	21.3	17.7	15.2	13.3	F	264	23%	94%	C	417	10%	71%	XC	470	9%	73%	UC	559	5%	62%	MR80-08	40290-08	\$17.16			
	0.98	60	58.2	38.8	29.1	23.3	19.4	16.6	14.5	F	247	26%	95%	M	390	11%	74%	XC	448	10%	76%	UC	539	5%	65%	DR80-08	40280-08	\$17.16			
10	0.87	30	51.4	34.3	25.7	20.6	17.1	14.7	12.9	M	405	12%	82%	C	512	7%	55%	UC	546	5%	62%	UC	611	4%	52%	ER80-10	40270-10	\$11.60			
	1.00	40	59.4	39.6	29.7	23.8	19.8	17.0	14.9	M	371	14%	84%	C	472	8%	63%	UC	513	6%	67%	UC	582	5%	57%	SR80-10	40288-10	\$17.16			
	1.12	50	66.4	44.3	33.2	26.6	22.1	19.0	16.6</																						

COMBO-JET® 110° Spray Tips

For full detailed application information, visit www.wilger.net.
Premium VITON™ options available: change part# to XXXX-VXXX
e.g. [Standard] 40287-015 // [VITON™] 40287-V015. See note* for VITON™ upcharge.

For the full chart of pressures, speeds and droplet size, refer to Tip Wizard or the Combo-Jet® Spray Tip Brochure.

Tip Cap Size	Flow Rate US gpm	PSI	Applied Rate - US Gal/Acre					Spray Classification, VMD (in µ); % <141µ (% Drift. Fines); %<600µ (% of small droplets)															Tip-Cap Description, Part #, & MSRP								
			Sprayer Speed - Miles/Hour					ER 110° Series			SR 110° Series			MR 110° Series			DR 110° Series			UR 110° Series*			Description	Part #	MSRP						
			5	7.5	10	12.5	15	20	Cl	VMD	<141	<600	Cl	VMD	<141	<600	Cl	VMD	<141	<600	Cl	VMD				<141	<600				
01	0.09	30	5.1	3.4	2.6	2.1	1.7	1.3	F	140	51%	100%	PRD TIP: For easier spray tip selection Full pressure & droplet size specifications for any nozzle spacing and speed is available on Tip Wizard. Download Tip Wizard for free on any smartphone/tablet, or use it at www.wilger.net															ER110-01	40281-01	\$8.70	
	0.10	40	5.9	4.0	3.0	2.4	2.0	1.5	F	133	56%	100%																Snap-in Strainers are shown on Page 5. 100 mesh strainer (#40251-00) for up to -02 50 mesh strainer (#40250-00) for -02 to -06			
	0.11	50	6.6	4.4	3.3	2.7	2.2	1.7	F	128	59%	100%																			
	0.12	60	7.3	4.8	3.6	2.9	2.4	1.8	F	124	62%	100%																			
015	0.13	30	7.7	5.1	3.9	3.1	2.6	1.9	F	145	47%	100%	F	215	24%	98%	C	322	11%	94%	C	366	7%	92%	-	-	-	-	ER110-015	40281-015	\$8.70
	0.15	40	8.9	5.9	4.5	3.6	3.0	2.2	F	139	52%	100%	F	199	28%	98%	C	277	16%	97%	C	328	10%	94%	-	-	-	-	SR110-015	40287-015	\$14.94
	0.17	50	10.0	6.6	5.0	4.0	3.3	2.5	F	134	55%	100%	F	187	32%	98%	M	247	20%	99%	C	301	12%	95%	-	-	-	-	SR110-015	40291-015	\$14.94
	0.18	60	10.9	7.3	5.5	4.4	3.6	2.7	F	131	58%	100%	F	177	34%	98%	M	225	23%	99%	C	281	14%	96%	-	-	-	-	DR110-015	40286-015	\$14.94
02	0.17	30	10.3	6.9	5.1	4.1	3.4	2.6	F	160	39%	100%	M	219	23%	99%	C	315	12%	95%	VC	431	5%	82%	-	-	-	-	ER110-02	40281-02	\$8.70
	0.20	40	11.9	7.9	5.9	4.8	4.0	3.0	F	151	45%	100%	F	206	26%	99%	C	279	15%	97%	VC	392	7%	87%	-	-	-	-	SR110-02	40287-02	\$14.94
	0.22	50	13.3	8.9	6.6	5.3	4.4	3.3	F	144	49%	100%	F	196	29%	99%	M	254	19%	97%	C	361	8%	90%	-	-	-	-	MR110-02	40291-02	\$14.94
	0.24	60	14.5	9.7	7.3	5.8	4.8	3.6	F	138	52%	100%	F	188	31%	99%	M	235	21%	98%	C	336	9%	92%	-	-	-	-	DR110-02	40286-02	\$14.94
025	0.22	30	12.9	8.6	6.4	5.1	4.3	3.2	F	186	29%	100%	M	236	20%	98%	C	350	9%	91%	VC	434	5%	80%	-	-	-	-	ER110-025	40281-025	\$8.70
	0.25	40	14.9	9.9	7.4	5.9	5.0	3.7	F	181	30%	100%	M	222	23%	98%	C	320	11%	93%	VC	398	7%	86%	-	-	-	-	SR110-025	40287-025	\$14.94
	0.28	50	16.6	11.1	8.3	6.6	5.5	4.2	F	176	30%	100%	F	211	25%	98%	C	296	13%	95%	C	370	8%	89%	-	-	-	-	MR110-025	40291-025	\$14.94
	0.31	60	18.2	12.1	9.1	7.3	6.1	4.5	F	173	31%	100%	F	203	27%	98%	M	277	15%	96%	C	347	9%	92%	-	-	-	-	DR110-025	40286-025	\$14.94
03	0.26	30	15.4	10.3	7.7	6.2	5.1	3.9	F	183	31%	99%	C	303	11%	95%	VC	394	6%	86%	XC	479	4%	74%	-	-	-	-	ER110-03	40281-03	\$8.70
	0.30	40	17.8	11.9	8.9	7.1	5.9	4.5	F	173	35%	98%	C	279	15%	96%	C	360	9%	91%	VC	443	5%	80%	-	-	-	-	SR110-03	40287-03	\$14.94
	0.34	50	19.9	13.3	10.0	8.0	6.6	5.0	F	165	37%	98%	M	260	17%	97%	C	333	10%	93%	VC	414	6%	84%	-	-	-	-	MR110-03	40291-03	\$14.94
	0.37	60	21.8	14.5	10.9	8.7	7.3	5.5	F	159	39%	97%	M	244	19%	97%	C	311	12%	94%	C	391	6%	86%	-	-	-	-	DR110-03	40286-03	\$14.94
04	0.35	30	20.6	13.7	10.3	8.2	6.9	5.1	M	225	22%	97%	C	314	11%	94%	VC	416	5%	84%	XC	510	3%	69%	UC	UR tips are specialty spray tips to produce ultra coarse spray.	ER110-04	40281-04	\$8.70		
	0.40	40	23.8	15.8	11.9	9.5	7.9	5.9	F	215	24%	96%	C	288	14%	95%	C	377	7%	89%	VC	469	4%	76%	UC	Refer to chemical application label for maximum pressures, speeds and application information.	SR110-04	40287-04	\$14.94		
	0.45	50	26.6	17.7	13.3	10.6	8.9	6.6	F	206	26%	96%	M	269	16%	96%	C	346	8%	92%	VC	438	5%	80%	UC	ER110-04	40291-04	\$14.94			
	0.49	60	29.1	19.4	14.5	11.6	9.7	7.3	F	199	28%	96%	M	253	17%	96%	C	321	9%	94%	VC	412	6%	83%	UC	DR110-04	40286-04	\$14.94			
05	0.53	70	31.4	21.0	15.7	12.6	10.5	7.9	F	194	29%	95%	M	239	19%	97%	C	300	10%	95%	C	391	6%	85%	UC	UR110-04	40292-04	\$27.15			
	0.43	30	25.7	17.1	12.9	10.3	8.6	6.4	M	226	22%	95%	C	355	8%	91%	XC	486	3%	72%	XC	530	2%	63%	UC	UR tips are specialty spray tips to produce ultra coarse spray.	ER110-05	40281-05	\$8.70		
	0.50	40	29.7	19.8	14.9	11.9	9.9	7.4	F	212	26%	95%	C	322	11%	93%	VC	445	5%	78%	XC	503	3%	68%	UC	Refer to chemical application label for maximum pressures, speeds and application information.	SR110-05	40287-05	\$14.94		
	0.56	50	33.2	22.1	16.6	13.3	11.1	8.3	F	202	28%	95%	C	296	13%	95%	VC	412	6%	82%	XC	482	3%	72%	UC	MR110-05	40291-05	\$14.94			
06	0.61	60	36.4	24.2	18.2	14.5	12.1	9.1	F	194	30%	95%	C	275	15%	96%	C	386	7%	85%	XC	465	3%	74%	UC	DR110-05	40286-05	\$17.16			
	0.66	70	39.3	26.2	19.6	15.7	13.1	9.8	F	187	32%	95%	M	257	16%	96%	C	364	7%	87%	VC	451	4%	76%	UC	UR110-05	40292-05	\$27.15			
	0.52	30	30.9	20.6	15.4	12.3	10.3	7.7	M	261	18%	94%	C	416	6%	84%	XC	507	3%	68%	XC	565	2%	57%	UC	UR tips are specialty spray tips to produce ultra coarse spray.	ER110-06	40281-06	\$8.70		
	0.60	40	35.6	23.8	17.8	14.3	11.9	8.9	M	246	20%	94%	C	371	8%	89%	XC	474	4%	74%	XC	529	2%	64%	UC	Refer to chemical application label for maximum pressures, speeds and application information.	SR110-06	40287-06	\$14.94		
08	0.67	50	39.8	26.6	19.9	15.9	13.3	10.0	M	235	22%	95%	C	337	10%	92%	VC	448	4%	78%	XC	501	3%	68%	UC	MR110-06	40291-06	\$17.16			
	0.73	60	43.6	29.1	21.8	17.5	14.5	10.9	M	225	24%	95%	C	308	12%	93%	VC	427	5%	81%	XC	478	3%	71%	UC	DR110-06	40286-06	\$17.16			
	0.79	70	47.1	31.4	23.6	18.9	15.7	11.8	F	217	25%	95%	C	284	13%	94%	VC	409	5%	83%	XC	459	3%	74%	UC	UR110-06	40292-06	\$27.15			
	0.69	30	41.2	27.4	20.6	16.5	13.7	10.3	M	290	17%	93%	XC	453	6%	67%	UC	531	4%	53%	UC	614	3%	40%	UC	UR tips are specialty spray tips to produce ultra coarse spray.	ER110-08	40281-08	\$8.70		
10	0.80	40	47.5	31.7	23.8	19.0	15.8	11.9	M	264	20%	95%	XC	408	7%	74%	UC	483	5%	61%	UC	569	4%	47%	UC	Refer to chemical application label for maximum pressures, speeds and application information.	SR110-08	40287-08	\$17.16		
	0.89	50	53.1	35.4	26.6	21.3	17.7	13.3	M	244	22%	95%	VC	374	9%	79%	XC	446	6%	67%	UC	534	4%	51%	UC	MR110-08	40291-08	\$17.16			
	0.98	60	58.2	38.8	29.1	23.3	19.4	14.5	M	228	23%	96%	C	346	10%	82%	XC	416	7%	70%	UC	506	4%	55%	UC	DR110-08	40286-08	\$17.16			
	1.06	70	62.9	41.9	31.4	25.1	21.0	15.7	F	214	25%	97%	C	322	11%	84%	XC	391	7%	73%	UC	482	5%	57%	UC	UR110-08	40292-08	\$27.15			
125	0.87	30	51.4	34.3	25.7	20.6	17.1	12.9	M	325	14%	90%	XC	470	6%	62%	UC	523	4%	53%	UC	609	5%	41%	UC	UR tips are specialty spray tips to produce ultra coarse spray.	ER110-10	40281-10	\$11.60		
	1.00	40	59.4	39.6	29.7	23.8	19.8	14.9	M	298	17%	92%	XC	424	7%	70%	XC	478	5%	59%	UC	584	5%	45%	UC	Refer to chemical application label for maximum pressures, speeds and application information.	SR110-10	40287-10	\$17.16		
	1.12	50	66.4	44.3	33.2	26.6	22.1	16.6	M	277	19%	93%	XC	388	8%	75%	XC	442	6%	64%	UC	565	6%	49%	UC	MR110-10	40291-10	\$17.16			
	1.22	60	72.7	48.5	36.4	29.1	24.2	18.2	M	260	21%	94%	VC	358	9%	79%	XC	413	6%	67%	UC	550	6%	52%	UC	DR110-10	40286-10	\$17.16			
15	1.32	70	78.6	52.4	39.3	31.4	26.2	19.6	F	246	22%	94%	C	333	10%	81%	XC	388	7%	70%	UC	537	6%	54%	UC	UR110-10	40292-10	\$27.15			
	1.08	30	64.3	42.9	32.2	2																									

Combo-Jet® 110° Spray Tip Charts For PWM Sprayers

For full detailed application information, visit www.wilger.net.

Spray Tip Charts For PWM Sprayers

! The following charts are based on spraying water in controlled settings, and cannot be replicated in field application. Standard PWM valve specifications are used to illustrate pressure drop. Check with your PWM manufacturer to verify pressure drop specifications.

LEGEND

Duty Cycle

Effective "on-time" of PWM systems adjust rates by the length of time the solenoid stays open (duty cycle), in order to keep pressure constant for controlled spray quality. Duty cycle is calculated by dividing your travel speed into the max speed of the spray tip at your pressure. Min/Max operating duty cycles are 40-100%. (confirm with PWM mfg.)

VMD

(Volume Median Diameter)
Size of the median droplet (in µ) for a sprayed volume. Half of the volume is made up of droplets smaller than VMD, with half made of droplets larger.

% <141µ (% Driftable Fines)
Percentage of volume which is likely to drift. As wind conditions and boom height increase, observed spray drift will increase substantially.

% <600µ (% Useful Droplets)
Percentage of volume which is made up of "small" droplets. As % of useful droplets lowers, coverage is reduced.

ASABE Spray Classification

(ASABE S572.1 Standard)
Spray quality is categorized based on Dv0.1 and VMD droplet sizes by 3rd party testing from spray spectrum recording equipment.

- Fine (F)
- Medium (M)
- Coarse (C)
- Very Coarse (VC)
- Extremely Coarse (XC)
- Ultra Coarse (UC)

Tip Cap No.	Flow Rate USGPM	Boom PSI	Tip PSI	Sprayer Speed Range (Rounded)					Spray Class.; VMD (Droplet Size in µ); %<141µ (Drift %); %<600µ (Small Droplets)												Tip-Cap & Part No.					
				@ US Gallons/Acre on 20" Spacing					ER110 Series			SR110 Series			MR110 Series			DR110 Series			Tip-Cap	Part #				
				5 GPA	7.5 GPA	10 GPA	12.5 GPA	15 GPA	Class	VMD	<141	<600	Class	VMD	<141	<600	Class	VMD	<141	<600	Class	VMD	<141	<600	Strainer	Part #
015	0.13	30	30	2-8	1-5	1-4	1-3	1-3	F	145	47%	100%	F	216	24%	98%	C	323	11%	94%	C	368	7%	92%	ER110-015	40281-015
	0.15	40	40	2-9	1-6	1-4	1-4	1-3	F	139	51%	100%	F	200	28%	98%	C	279	16%	97%	C	329	10%	94%	SR110-015	40287-015
	0.17	50	50	2-10	2-7	1-5	1-4	1-3	F	135	55%	100%	F	188	32%	98%	M	248	20%	98%	C	302	12%	95%	MR110-015	40291-015
	0.18	60	59	3-11	2-7	1-5	1-4	1-4	F	131	58%	100%	F	178	34%	98%	M	226	23%	99%	C	282	14%	96%	DR110-015	40286-015
	0.20	70	69	3-12	2-8	1-6	1-5	1-4	F	128	61%	100%	F	169	37%	98%	F	209	25%	99%	M	265	15%	97%	100 Mesh Strainer	
	0.21	80	79	3-13	2-8	2-6	1-5	1-4	F	125	63%	100%	F	162	39%	98%	F	195	27%	100%	M	252	17%	97%	[Green]	
02	0.17	30	29	3-10	2-7	1-5	1-4	1-3	F	160	39%	100%	M	220	22%	99%	C	317	11%	95%	VC	433	5%	82%	ER110-02	40281-02
	0.20	40	39	3-12	2-8	1-6	1-5	1-4	F	151	45%	100%	F	207	26%	99%	C	281	15%	97%	VC	394	6%	87%	SR110-02	40287-02
	0.22	50	49	3-13	2-9	2-7	1-5	1-4	F	144	49%	100%	F	197	28%	99%	M	256	18%	97%	C	364	8%	90%	MR110-02	40291-02
	0.24	60	59	4-14	2-10	2-7	1-6	1-5	F	138	52%	100%	F	189	31%	99%	M	237	21%	98%	C	339	9%	91%	DR110-02	40286-02
	0.26	70	69	4-16	3-10	2-8	2-6	1-5	F	133	55%	100%	F	182	32%	99%	M	222	23%	98%	C	318	10%	93%	50 Mesh Strainer	
	0.28	80	79	4-17	3-11	2-8	2-7	1-6	F	129	58%	100%	F	176	34%	99%	F	210	25%	99%	C	299	11%	94%	[Blue]	
025	0.21	30	29	3-13	2-8	2-6	1-5	1-4	F	187	29%	100%	M	237	19%	98%	C	353	8%	90%	VC	437	5%	79%	ER110-025	40281-025
	0.25	40	39	4-15	2-10	2-7	1-6	1-5	F	181	30%	100%	M	223	22%	98%	C	322	11%	93%	VC	401	6%	86%	SR110-025	40287-025
	0.28	50	49	4-16	3-11	2-8	2-7	1-5	F	177	30%	100%	F	213	25%	98%	C	299	13%	95%	C	373	8%	89%	MR110-025	40291-025
	0.30	60	58	4-18	3-12	2-9	2-7	1-6	F	173	31%	100%	F	204	27%	98%	C	280	15%	96%	C	350	9%	91%	DR110-025	40286-025
	0.33	70	68	5-19	3-13	2-10	2-8	2-6	F	170	31%	100%	F	196	28%	98%	M	263	16%	96%	C	331	10%	93%	50 Mesh Strainer	
	0.35	80	78	5-21	3-14	3-10	2-8	2-7	F	168	31%	100%	F	190	30%	98%	M	249	18%	97%	C	314	10%	94%	[Blue]	
03	0.26	30	29	4-15	3-10	2-8	2-6	1-5	F	185	31%	99%	C	307	11%	95%	VC	399	6%	86%	XC	484	3%	73%	ER110-03	40281-03
	0.29	40	39	4-17	3-12	2-9	2-7	1-6	F	175	34%	98%	C	282	14%	96%	C	364	8%	90%	VC	447	5%	79%	SR110-03	40287-03
	0.33	50	48	5-20	3-13	2-10	2-8	2-7	F	167	37%	98%	M	263	17%	97%	C	337	10%	93%	VC	419	6%	83%	MR110-03	40291-03
	0.36	60	58	5-21	4-14	3-11	2-9	2-7	F	160	39%	97%	M	247	19%	97%	C	315	11%	94%	C	396	6%	86%	DR110-03	40286-03
	0.39	70	68	6-23	4-15	3-12	2-9	2-8	F	155	41%	97%	M	234	20%	97%	C	297	13%	95%	C	376	7%	88%	50 Mesh Strainer	
	0.42	80	77	6-25	4-16	3-12	2-10	2-8	F	150	42%	97%	M	223	22%	98%	C	281	14%	96%	C	359	8%	89%	[Blue]	
0.44	90	87	7-26	4-17	3-13	3-10	2-9	F	146	44%	96%	F	213	23%	98%	M	266	14%	96%	C	344	8%	91%	40250-00		

High Flow Spray Tip Charts For PWM Sprayers



Download TIP WIZARD for your personal spray tip calculator for both PWM & Standard Spraying.

www.wilger.net

Tip Cap No.	Flow Rate USGPM	BOOM PSI	TIP PSI	Sprayer Speed Range (Rounded)					Spray Classification; VMD (Droplet Size in µ); %<141µ (Drift %); %<600µ (Small Droplets)												Tip-Cap & Part No.							
				@ US Gallons/Acre on 20" Spacing					ER110 Series			SR110 Series			MR110 Series			DR110 Series			UR Tip Usage	Strainer not req'd						
				5 GPA	7.5 GPA	10 GPA	15 GPA	20 GPA	Class	VMD	<141	<600	Class	VMD	<141	<600	Class	VMD	<141	<600	Class	VMD	<141	<600	Class	UR Tip Usage	Strainer not req'd	
04	0.34	30	28	5-20	3-13	2-10	2-7	1-5	M	228	21%	97%	C	319	10%	93%	VC	425	4%	83%	-	-	-	-	UR tips are specialty spray tips to produce ultra coarse spray.	ER110-04	40281-04	
	0.39	40	37	6-23	4-15	3-12	2-8	1-6	M	217	24%	97%	C	294	13%	95%	C	386	6%	88%	XC	478	4%	74%	UC	Refer to chemical application label for maximum pressures, speeds and application information.	SR110-04	40287-04
	0.43	50	47	6-26	4-17	3-13	2-9	2-6	F	209	26%	96%	C	275	15%	96%	C	355	8%	91%	VC	447	5%	79%	UC	MR110-04	40291-04	
	0.47	60	56	7-28	5-19	4-14	2-9	2-7	F	202	27%	96%	M	259	17%	96%	C	330	9%	93%	VC	421	6%	82%	UC	DR110-04	40286-04	
	0.51	70	66	8-30	5-20	4-15	3-10	2-8	F	196	29%	96%	M	245	18%	97%	C	309	10%	95%	C	400	6%	84%	UC	UR110-04	40292-04	
	0.55	80	75	8-33	5-22	4-16	3-11	2-8	F	191	30%	95%	M	233	19%	97%	C	291	11%	95%	C	381	7%	86%	UC			
05	0.58	90	84	9-35	6-23	4-17	3-12	2-9	F	187	31%	95%	M	223	21%	97%	C	275	12%	96%	C	365	7%	87%	UC			
	0.48	40	36	7-28	5-19	4-14	2-9	2-7	M	217	25%	95%	C	334	10%	93%	VC	459	4%	76%	XC	513	3%	66%	UC	UR tips are specialty spray tips to produce ultra coarse spray.	ER110-05	40281-05
	0.53	50	45	8-32	5-21	4-16	3-11	2-8	F	207	27%	95%	C	308	12%	94%	VC	427	5%	80%	XC	492	3%	70%	UC	Refer to chemical application label for maximum pressures, speeds and application information.	SR110-05	40287-05
	0.58	60	54	9-35	6-23	4-17	3-12	2-9	F	198	29%	95%	C	287	14%	95%	C	400	6%	83%	XC	475	3%	73%	UC	MR110-05	40291-05	
	0.63	70	63	9-37	6-25	5-19	3-12	2-9	F	192	31%	95%	M	269	15%	96%	C	378	7%	85%	XC	460	4%	75%	UC	DR110-05	40286-05	
	0.67	80	72	10-40	7-27	5-20	3-13	2-10	F	186	32%	95%	M	253	17%	97%	C	359	7%	87%	VC	448	4%	77%	UC	UR110-05	40292-05	
06	0.71	90	82	11-42	7-28	5-21	4-14	3-11	F	181	34%	95%	M	240	18%	97%	C	342	8%	88%	VC	437	4%	78%	UC			
	0.56	40	35	8-33	6-22	4-17	3-11	2-8	C	253	19%	94%	C	393	7%	87%	XC	490	3%	71%	XC	547	2%	61%	UC	UR tips are specialty spray tips to produce ultra coarse spray.	ER110-06	40281-06
	0.63	50	43	9-37	6-25	5-19	3-12	2-9	C	242	21%	95%	C	358	9%	90%	XC	465	4%	76%	XC	519	3%	65%	UC	Refer to chemical application label for maximum pressures, speeds and application information.	SR110-06	40287-06
	0.69	60	52	10-41	7-27	5-20	3-14	3-10	M	233	23%	95%	C	330	11%	92%	VC	443	5%	79%	XC	496	3%	69%	UC	MR110-06	40291-06	
	0.74	70	61	11-44	7-29	5-22	4-15	3-11	M	225	24%	95%	C	306	12%	93%	VC	426	5%	81%	XC	476	3%	71%	UC	DR110-06	40286-06	
	0.79	80	70	12-47	8-31	6-24	4-16	3-12	M	218	25%	95%	C	285	13%	94%	VC	410	5%	83%	XC	460	3%	73%	UC			

COMBO-JET® & Radialock Caps, Accessories & Adapters

Combo-Jet® & Square Lug Outlet Adapters

40204-00	SQ LUG TO COMBO-JET ADAPTER - LOCK RING STYLE	\$2.55
40202-00	HARDI TO COMBO-JET ADAPTER - SNAP-ON	\$2.55
40203-00	COMBO-JET TO SQ LUG ADAPTER	\$2.55
40200-00	SQ LUG TO COMBO-JET ADAPTER - SNAP-ON	\$2.55

Adapters are available [above] to convert a square lug nozzle outlet (e.g. Teejet, Hypro, Arag, etc.) to Combo-Jet® Outlets, or vice versa.

40204-00
SQ LUG
To CJ
-TWISTLOCK-



40200-00
SQ LUG
To CJ
-SNAP-



For VITON™ O-ring options, contact Wilger.

CANADA 1 (833) 242-4121
USA 1 (877) 968-7695

40203-00
CJT
SQ LUG
-TURN-



40202-00
HARDI
To CJ
-SNAP-



Radialock Caps & Flanged Spray Tips (for use on Combo-Jet® outlets)

(Different color caps available as non-stocked item. Black is standard. Order item number XXXXX-01 for Red; -02 for White; -03 for Green; -04 for Yellow)

Radialock Slotted Caps (caps require 40160-00 seal)

40269-05	RADIALOCK CAP - UNIVERSAL SLOT	\$0.98
40271-06	RADIALOCK CAP - ROUND	\$1.10
40275-05	RADIALOCK CAP - HARDI	\$1.10
40276-05	RADIALOCK CAP - WIDE	\$1.10
40279-05	RADIALOCK CAP - HIGH FLOW SLOT	\$1.10
40160-00	RADIALOCK NOZZLE GASKET, UNIVERSAL, EPDM	\$0.56

For standard Teejet/Hypro/etc spray tips



ER Series Flanged Spray Tips - Refer to Page 3/4 for Spray Tip Application Information

Tip Size	-005	-0067	-01	-015	-02	-025	-03	-04	-05	-06	-08
80° ER Tip Part#	ER80-005	ER80-007	ER80-01	ER80-015	ER80-02	ER80-025	ER80-03	ER80-04	ER80-05	ER80-06	ER80-08
110° ER Tip Part #	40170-005	40170-007	ER110-01	ER110-015	ER110-02	ER110-025	ER110-03	ER110-04	ER110-05	ER110-06	ER110-08
MSRP	\$14.95	\$14.94	\$8.70	\$8.70	\$8.70	\$8.70	\$8.70	\$8.70	\$8.70	\$8.70	\$8.70



40169-04

40170-04

40160-00

Combo-Jet® Caps, Metering Orifices & Accessories

(Different color caps available as non-stocked item. Black is standard. Order item number XXXXX-01 for Red; -02 for White; -03 for Green; -04 for Yellow)

Spray Tip Strainers & O-Rings for Radialock Caps

40250-00	CJ TIP STRAINER, SNAP-IN, 50 MESH, BLUE	\$1.87
40251-00	CJ TIP STRAINER, SNAP-IN, 100 MESH, GREEN	\$1.87
40260-00	CJ NOZZLE SEAL - 13 mm X 3 mm	\$0.26
40260-V0	CJ NOZZLE SEAL - 13 mm X 3 mm, VITON®	\$2.13
40261-00	CJ SEAL/STRAINER ADAPTER	\$0.42
40285-XX	PRE-ORIFICES (See Page 3/4 for flow rates)	\$5.91

PRODUCT UPGRADE: FKM O-rings

Wilger parts are now being manufactured with fluor elastomer (FKM) o-rings & seals. FKM o-rings provides superior chemical resistance and durability over Buna-N (previous standard). VITON™ premium branded o-rings are available for greater chemical resistance.

VITON™ is a registered trademark of The Chemours Company™.

Hose Barb, Quick-Connect Push-in Tube & Other Radialock Caps

Cap Description	FKM O-ring Assy	Cap Only
Wye Splitter	40440-00 \$5.11	40440-01 \$4.88
Plug	40272-B5 \$1.46	40272-05 \$1.10
Hose Barb	1/8" 40420-B5 \$2.34	40420-05 \$1.39
	1/4" 40422-B5 \$2.34	40422-05 \$1.39
	3/8" 40424-B5 \$2.34	40424-05 \$1.39
	1/2" 40426-B5 \$2.34	40426-05 \$1.39
Push-In	1/4" 40435-B5 \$5.13	40435-05 \$4.18
	1/2" 40437-B5 \$5.27	40437-05 \$4.32
Tube [Size = tube O.D.]	3/8" 40436-B5 \$5.27	40436-05 \$4.32
	1/8" 40277-B5 \$2.34	40277-05 \$1.39
NPT-F	1/4" 40273-B5 \$2.34	40273-05 \$1.39
	45° NPT-F 1/4" 40274-B5 \$4.18	40274-05 \$3.22

O-ring(s) for Combo-Jet® Caps & Spray Tips



Types of metering orifices for Combo-Jet® caps



COMBO-JET® UR SERIES DUAL-CHAMBER ORIFICES [Replacement only]

Orifice Size	-04	-05	-06	-08	-10
Part #	40292-24	40292-25	40292-26	40292-28	40292-30
MSRP	\$11.40	\$11.40	\$11.40	\$11.40	\$11.40

UR series orifices cannot be intermixed. Orifices must be replaced with a new pair only. Correct orifices must be used for proper performance.

COMBO-JET® METERING ORIFICES - Refer to Page 3/4 for Flow Rate Information

Orifice Size	-005	-0067	-01	-015	-02	-025	-03	-04	-05	-06	-08	-10	-125	-15	-20	-25	-30	-40	-50	
Part #	40285-005	40285-007	40285-01	40285-015	40285-02	40285-025	40285-03	40285-04	40285-05	40285-06	40285-08	40285-10	40285-125	40285-15	40285-20	40285-25	40285-30	40285-40	40285-50	
MSRP	\$7.85	\$7.85	\$5.91	\$5.91	\$5.91	\$5.91	\$5.91	\$5.91	\$5.91	\$5.91	\$5.91	\$5.91	\$5.91	\$5.91	\$5.91	\$5.91	\$5.91	\$5.91	\$5.91	
Strainer #	100 Mesh Strainer [Green] #40251-00										50 Mesh Strainer [Blue] #40250-00									
MSRP	\$1.87										\$1.87									

CAP ASSEMBLIES:

#40424-B5 Breakdown

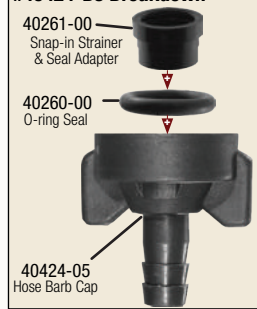

Combo-Jet® Fertilizer Streamer Caps & Strainers

Two-Hole Fertilizer Streamer Caps (Cap ONLY*, for ~15" spacing)

40432-047	CJ FERTILIZER CAP, 2-HOLE @ 0.0469"	\$7.79
40432-086	CJ FERTILIZER CAP, 2-HOLE @ 0.086"	\$7.79
40432-104	CJ FERTILIZER CAP, 2-HOLE @ 0.104"	\$7.79

Three-Hole Fertilizer Streamer Caps (Cap ONLY*, for ~20" spacing)

40433-047	CJ FERTILIZER CAP, 3-HOLE @ 0.0469"	\$9.98
40433-067	CJ FERTILIZER CAP, 3-HOLE @ 0.067"	\$9.98
40433-086	CJ FERTILIZER CAP, 3-HOLE @ 0.086"	\$9.98
40433-104	CJ FERTILIZER CAP, 3-HOLE @ 0.104"	\$9.98

Slotted Strainers

40247-00	CJ SLOTTED STRAINER - 16 MESH, GREY	\$1.85
40248-00	CJ SLOTTED STRAINER - 25 MESH, YELLOW	\$1.85
40249-00	CJ SLOTTED STRAINER - 50 MESH, RED	\$1.85

For selecting metering orifices to fit your application, use Tip Wizard (at www.wilger.net/tip-wizard), consult flow charts, or use other tools available at www.wilger.net.

Fertilizer Streamer Cap Assembly

Strainer (optional) (avail in 16, 25, 50 mesh) 40248-00

Long Metering Orifice (for high volume orifices) 40285-XX

25 Mesh Strainer

O-ring Seal 40260-00 FKM VITON™

40285-XX Short Metering Orifice (allows strainer attachment)

HOW TO ORDER: Streamer Caps

- *For full cap assembly, order:
1. Metering Orifice (40285-XX series)
 2. Streamer cap (2 hole or 3 hole)
 3. O-ring seal (40260-00 or 40260-V0)
 - [Optional] 4. Strainer (based on orifice size)

Radialock Hose-Drop Cap Assemblies

For premium VITON™ O-ring options, contact Wilger.

CANADA 1 (833) 242-4121
USA 1 (877) 968-7695

22021-00	16" NYLON HOSE DROP - 1/4" NPT-M x 1/4" NPT-M	\$11.13
22025-00	16" NYLON HOSE DROP - 1/4" NPT-F x 1/4" NPT-M	\$12.92
22026-00	16" NYLON HOSE DROP - R/L CAP x 1/4" NPT-M	\$10.74
22031-00	24" NYLON HOSE DROP - 1/4" NPT-M x 1/4" NPT-M	\$14.44
22035-00	24" NYLON HOSE DROP - 1/4" NPT-M x 1/4" NPT-F	\$16.23
22036-00	24" NYLON HOSE DROP - R/L CAP x 1/4" NPT-M	\$14.02
22048-00	48" NYLON HOSE DROP - R/L CAP x 1/4" NPT-M	\$23.87

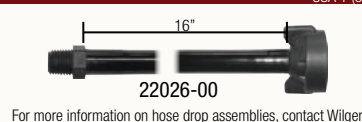

For more information on hose drop assemblies, contact Wilger.

Square-Lug Caps, Plugs & Strainers

40150-00	FLANGED TIP STRAINER, 50 MESH, BLUE	\$1.12
40151-00	FLANGED TIP STRAINER, 100 MESH, GREEN	\$1.12
40159-05	SQ LUG NOZZLE CAP, 3/8" TIP, BLACK	\$0.82
40160-00	SQ LUG NOZZLE GASKET, UNIVERSAL	\$0.56
40160-V0	SQ LUG NOZZLE GASKET, UNIVERSAL, VITON®	\$2.87
40198-SM	SQ LUG NOZZLE GASKET, SMALLER OD, EPDM	\$0.56
40164-00	SQ LUG CAP, 1/4" NPT FE, 45° BLACK	\$3.21
40180-05	SQ LUG NOZZLE CAP, BLACK	\$2.11



Contact Wilger for alternate color cap availability.

CANADA 1 (833) 242-4121
USA 1 (877) 968-7695

Other Combo-Jet® Metering Setups

Wet Boom Metering PAGE 8

ORS Manifold Metering PAGE 14

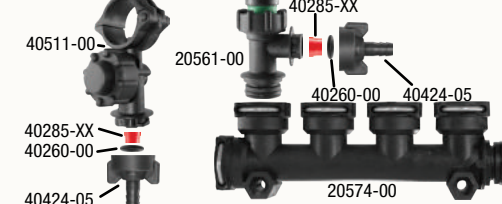

COMBO-JET® Nozzle Bodies & Accessories

Easier to Use. Built Tougher. Proven.

For Full COMBO-JET® Nozzle Body Brochure, visit www.wilger.net

Wet Boom Nozzle Bodies

Nozzle Bodies also available with smooth clamps. Contact Wilger for part numbers.

Combo-Jet® Wet Boom Nozzle Bodies

For premium VITON™ O-ring options, contact Wilger.

CANADA 1 (833) 242-4121
USA 1 (877) 968-7695

Outlets	3/4" Wet Boom	1" Wet Boom	1" KWIKSTOP
Single	40611-00 \$5.74	40621-00 \$5.74	40631-00 \$7.72
Dual	40612-00 \$14.78	40622-00 \$14.78	40632-00 \$16.77
Triple	40613-00 \$18.19	40623-00 \$18.19	40633-00 \$20.17



HOW TO ORDER: Low/High PSI Check Valves

- 4 PSI (Replace '-00' with '-P4')
- 10 PSI (Standard as a '-00')
- 15 PSI (Replace '-00' with '-P15')

PRODUCT CHANGE: Diaphragms

OLD Two-piece diaphragm & pressure pad O-ring	NEW One-piece Integrated diaphragm/O-ring
Diaphragm 40155-07 (EDPM) 40155-12 (Viton™)	Pressure pad O-Ring 20455-04 (Buna-N) 20455-V4 (Viton™)
has changed to	Diaphragm 40155-23 (FKM)

Retro-fittable single molded seal replaces both the diaphragm and pressure pad o-ring.

Square Lug Wet Boom Nozzle Bodies

Outlets	3/4" Wet Boom	1" Wet Boom	1" KWIKSTOP
Single	40651-00 \$5.74	40661-00 \$5.74	40671-00 \$7.72
Dual	40652-00 \$14.78	40662-00 \$14.78	40672-00 \$16.77
Triple	40653-00 \$18.19	40663-00 \$18.19	40673-00 \$20.17
Single w/o Dia. Check	40140-00 \$4.24	40141-00 \$4.24	N/A

WHAT IS?: KWIKSTOP™ Raised Inlets

KWIKSTOP™ nozzle bodies aspirate trapped air in the boom.
Less air = Less Drips & Run-on

KWIKSTOP™ is a trademark, owned by BRANDT INDUSTRIES LTD.



PRODUCT CHANGE: Bolt-mount clamp

5/16" bolt-mount clamps is the standard for Combo-Jet swivel bodies. Smooth clamps will continue to be available as a non-stocked option.

Contact Wilger for smooth clamp part numbers.

- 40166-04 O-RING REPAIR KIT (6 BODIES) - FKM\$15.87
- 40166-05 O-RING REPAIR KIT (6 BODIES) - Viton®\$44.61
- 40155-07 DIAPHRAGM, EPDM\$0.97
- 40155-12 DIAPHRAGM, Viton\$3.43

- CJ Nozzle Body Repair Kits (6 bodies)** BUNA-N Kit incl. VITON™ Kit incl.
- 6x Pressure Pad O-rings #20455-04 #20455-V4
 - 24x Inner-body O-rings #40155-09 #40155-13
 - 6x Diaphragms #40155-07 #40155-12

Combo-Jet® Turret Adapters For Radiallock & Square Lug Outlets

For premium VITON™ O-ring options, contact Wilger.

CANADA 1 (833) 242-4121
USA 1 (877) 968-7695

Combo-Jet® Adapter (Radiallock to Combo-Jet® Cap)

- 40470-00 DUAL BODY ADAPTER - COMBO-JET®\$10.83
- 40471-00 TRIPLE BODY ADAPTER - COMBO-JET®\$14.88

Square Lug Adapter (Radiallock to Square Lug Cap)

- 40472-00 DUAL BODY ADAPTER - SQUARE LUG\$10.83
- 40473-00 TRIPLE BODY ADAPTER - SQUARE LUG\$14.88



Combo-Rate® Nozzle Body Components & U-clip Accessories

- 40155-07 DIAPHRAGM - Buna-N\$0.97
- 40155-12 DIAPHRAGM - VITON®\$3.43
- 20455-04 DIAPHRAGM O RING (Use with 40155-07/-12)\$0.25
- 40155-23 INTEGRATED DIAPHRAGM & O-ring\$1.23
- 41100-02 COMBO-RATE BODY NUT\$1.50
- 41100-03 COMBO-RATE DIAPHRAGM MODULE ASSY\$3.00
- 41110-01 COMBO-RATE SHUT-OFF MODULE ASSY\$4.48
- 41125-01 AIR-OFF MODULE ASSY\$11.87
- 20455-00 AIR TEE, 3/8" x 3/8" x 1/4"\$9.23
- 20456-00 REDUCING ADAPTER, 3/8" x 1/4" TUBE\$4.11
- 20457-00 AIR TEE, 5/16" x 5/16" x 1/4"\$9.32
- 41250-00 COMBO-CLIP (C/C) 90° ELBOW M/FE ASSY\$6.66
- 41251-00 C/C /RADIALLOCK BODY/ NPTF 1/4" ADAPTER ASSY\$4.62
- 41252-00 C/C FE x 1/4" NPT MALE ADAPTER ASSY\$2.65
- 41253-00 C/C FE x 3/8" NPT MALE ADAPTER ASSY\$2.65
- 41255-00 C/C FE x 1/4" NPT FE x 3/4" SQ. MOUNT ADAPTER\$3.87
- 41256-00 C/C FE x 3/8" NPT FE x 3/4" SQ. MOUNT ADAPTER\$3.87
- 41275-00 ADAPTER, C/C MALE x 1/4" NPT FEMALE\$2.22
- 41276-00 ADAPTER, C/C MALE x 3/8" NPT FEMALE\$2.22
- 41285-00 ADAPTER, C/C MALE x PLUG\$1.74
- 41133-01 COMBO-RATE / PWM ADAPTER NUT\$1.61
- 41150-00 CR INTER-BODY STRAINER, 50 MESH, RED\$2.47
- 41152-00 CR INTER-BODY STRAINER, 80 MESH, GREY\$2.47
- 41151-00 CR INTER-BODY STRAINER, 100 MESH, GREEN\$2.47



HOW TO ORDER: High/Low Pressure Diaphragm Check Valves

41100-03	41100-11	41110-01
Diaphragm Check Valves		
PSI Shut-off	Part #	Color
10 PSI (Standard)	41100-03	BLACK
4 PSI (Low)	41100-12	BLUE
15 PSI (High)	41100-11	RED
Manual On/Off Check Valves		
PSI Shut-off	Part #	Color
10 PSI (Standard)	41110-01	BLACK
4 PSI (Low)	41110-09	BLUE
15 PSI (High)	41110-08	RED

To order 4 PSI or 15 PSI nozzle bodies, replace '-00' with '-P4' (4 PSI) or '-P15' (15 PSI) i.e. #40517-P15: C/J dual body w/ 15 PSI diaphragm check valve

PRODUCT UPDATE: Rubber Diaphragm Change

OLD Two-piece diaphragm & pressure pad O-ring	NEW One-piece Integrated diaphragm & O-ring
Diaphragm 40155-07 (EDPM) 40155-12 (Viton™)	Pressure pad O-Ring 20455-04 (Buna-N) 20455-V4 (Viton™)
	Diaphragm 40155-23 (FKM)

Retro-fittable single molded seal replaces both the diaphragm & pressure pad o-ring.

Combo-Rate® Boomless Sprayer Nozzle Body Assemblies

For VITON™ assembly options, contact Wilger.

CANADA 1 (833) 242-4121
USA 1 (877) 968-7695

Boomless sprayers are used to spray areas not accessible by a boom sprayers. For example: ditches, roadways, etc.

Assembly	Flow Rate	Part #	MSRP
3-Tip Boomless Assembly	1.3 US gpm	70154-01	\$137.05
	2.6 US gpm	70154-03	
	1.3 US gpm	70154-06	
5-Tip Boomless Assembly	2.3 US gpm	70155-02	\$219.08
	2.9 US gpm	70155-03	
	5.8 US gpm	70155-06	
	11.5 US gpm	70155-12	
7-Tip Boomless Assembly	3.9 US gpm	70156-04	\$302.57
	4.9 US gpm	70156-05	
	9.6 US gpm	70156-10	
	19.5 US gpm	70156-20	



Example boomless nozzle assembly on a service utility truck.

Adjustable swath distance charts online

Easy-to-follow charts are online to help you configure your swath distance to your application needs.

Find them at **WWW.WILGER.NET**

Compact Nozzle Bodies

Model	10 PSI Check	4 PSI Check	MSRP
1/8" NPT-F	40500-00	40500-P4	\$8.22
1/4" NPT-F	40501-00	40501-P4	\$8.23
1/4" Push-In	40502-00	40502-P4	\$11.13

- 40497-00 COMPACT BODY, 1/4" NPT FE\$2.30
- 40498-00 COMPACT BODY, 3/8" NPT FE\$2.30



Use as an in-line Check Valve

The compact nozzle bodies work as an in-line check valve for liquid fertilizer kits and on other application equipment.

COMBO-RATE® Nozzle Bodies

The Nozzle Body That Can Do More

For Full COMBO-RATE® Nozzle Body Brochure, visit www.wilger.net

NOTE: All Wilger u-clip (male to female connections) components are compatible with COMBO-RATE® nozzle bodies and stacking components.

Combo-Rate® Side-Fed Inlet Saddles

For premium VITON™ O-ring options, contact Wilger.

CANADA 1 (833) 242-4121
USA 1 (877) 968-7695

Boom Size	Inlet Size	Part # MSRP
3/4" Boom	3/8" Inlet	41203-00 \$6.75
1" Boom	3/8" Inlet	41200-00 \$6.75
	9/16" Inlet	41201-00 \$6.75
2" Boom	9/16" Inlet	41206-00 \$7.85



Combo-Rate® II Bottom-Fed or Top-Fed Saddles

For premium VITON™ O-ring options, contact Wilger.

CANADA 1 (833) 242-4121
USA 1 (877) 968-7695

Boom Size	Inlet Size	Stacking Direction	Part # & MSRP	
			Standard	Bolt Mount
1/2" Boom	3/8" Inlet	One-Way	41371-00 \$6.42	41471-00 \$6.42
		Two-Way	41372-00 \$8.08	41472-00 \$8.08
1" Boom	3/8" Inlet	One-Way	41375-00 \$6.42	41475-00 \$6.42
		Two-Way	41376-00 \$8.08	41476-00 \$8.08
	9/16" Inlet	One-Way	41377-00 \$6.42	41477-00 \$6.42
		Two-Way	41378-00 \$8.08	41478-00 \$8.08



Combo-Rate® II Stacking Nozzle Bodies

For premium VITON™ O-ring options, contact Wilger.

CANADA 1 (833) 242-4121
USA 1 (877) 968-7695

Boom Size	Inlet Size	Stacking Direction	Nozzle Bodies with Smooth Upper Clamp			
			Description, Part# & MSRP			
			Dia. Check Valve	Manual ON/OFF	Air-Off Operated	PWM (w/o Nut)**
1/2" Boom	3/8" Inlet	One-Way	41311-00 \$15.04	41313-00 \$16.65	41315-00 \$19.70	41317-00 \$10.06
		Two-Way	41312-00 \$16.69	41314-00 \$18.31	41316-00 \$21.36	41318-00 \$11.72
3/4" Boom	3/8" Inlet	One-Way	41321-00 \$15.04	41323-00 \$16.65	41325-00 \$19.70	41327-00 \$10.06
		Two-Way	41322-00 \$16.69	41324-00 \$18.31	41326-00 \$21.36	41328-00 \$11.72
28mm Boom	3/8" Inlet	One-Way	41381-00 \$15.04	41383-00 \$16.65	41385-00 \$19.70	41387-00 \$10.06
		Two-Way	41382-00 \$16.69	41384-00 \$18.31	41386-00 \$21.36	41388-00 \$11.72
		One-Way	41331-00 \$15.04	41333-00 \$16.65	41335-00 \$19.70	41337-00 \$10.06
		Two-Way	41332-00 \$16.69	41334-00 \$18.31	41336-00 \$21.36	41338-00 \$11.72
1" Boom	3/8" Inlet	One-Way KWIKSTOP	41351-00 \$16.71	41353-00 \$18.50	41355-00 \$21.81	41357-00 \$11.18
		Two-Way KWIKSTOP	41352-00 \$18.55	41354-00 \$20.34	41356-00 \$23.65	41358-00 \$13.02
		One-Way	41341-00 \$15.04	41343-00 \$16.65	41345-00 \$19.70	41347-00 \$10.06
		Two-Way	41342-00 \$16.69	41344-00 \$18.31	41346-00 \$21.36	41348-00 \$11.72
	High Flow 2 1/32" Inlet	Two-Way	41362-00 \$16.69	41364-00 \$18.31	41366-00 \$21.36	41368-00 \$11.72

**PWM bodies/turrets do not include a body nut

HOW TO ORDER: CR11 bodies with VITON™ O-rings



Replace ##### **XO** in part number with a **V**
e.g. 1" Two-Way Manual On/Off Nozzle Body w/ VITON Seals
Replace 41334-**00** to 41334-**V0**

HOW THEY WORK: Manual ON/OFF Check Valves

Since Combo-Rate nozzle bodies stack, a manual way to turn off flow to certain outlets is required.

When the knob is **OPEN**, it acts as a standard 10 PSI check valve.

When the knob is **CLOSED**, it turns off flow to that nozzle outlet **ONLY**. It does not effect other stacked nozzle bodies.

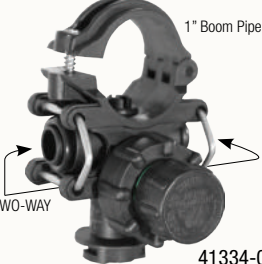

HOW TO ORDER: 5/16" bolt-mount clamps for nozzle bodies



Replace 41X##-00 in part number with a **4**
e.g. 1" Two-Way Manual On/Off Nozzle Body w/ bolt mount
Replace 41334-00 to 41434-00
For retro-fitting, 5/16" bolt mount clamps can be ordered separately:

- [1/2" Boom bolt-mount clamp] #41411-02
- [3/4" Boom bolt-mount clamp] #41421-02
- [28mm Boom bolt-mount clamp] #41481-02
- [1" Boom bolt-mount clamp] #41431-02

Nozzle bodies are listed as One-Way or Two-Way nozzle bodies, based on how many open u-clip (or combo-clip) ports are available.

COMBO-RATE® STACKING COMPONENTS & ACCESSORIES

COMBO-RATE® Side-Fed Saddles



COMBO-RATE® II Top/Bottom-Fed Saddles

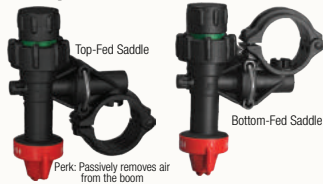

COMBO-RATE® II Bottom-Fed Nozzle Body



COMBO-RATE® Stacking Components



Combo-Rate® Stacking Thru/End Nozzle Bodies (use with Combo-Rate® saddle bodies)

For premium VITON™ O-ring options, contact Wilger. CANADA 1 (833) 242-4121 USA 1 (877) 968-7695

Model	Part # & MSRP			
	Dia. Check Valve	Manual ON/OFF	Air-Off Operated	PWM (w/o nut)**
Thru Body Assembly	41100-00 \$9.79	41110-00 \$11.18	41125-00 \$14.23	41135-00 \$4.43
End Body Assembly	41101-00 \$8.93	41111-00 \$10.38	41126-00 \$13.43	41136-00 \$3.31



41285-00 ADAPTER, C/C MALE x PLUG.....\$1.74

** PWM bodies/turrets do not include a body nut. Control module or solenoid must be used.

Combo-Rate® Stacking Turrets (use with Combo-Rate® saddle bodies)

For premium VITON™ O-ring options, contact Wilger. CANADA 1 (833) 242-4121 USA 1 (877) 968-7695

Combo-Rate® Standard (Front Mount) Turrets

Multi-Outlet Turrets with control module stacked on the front of the turret.

Model	Part # & MSRP			
	Dia. Check Valve	Manual ON/OFF	Air-Off Operated	PWM (w/o nut)**
3 Outlet Turret Body	41503-00 \$19.62	41513-00 \$21.02	41543-00 \$24.07	41533-00 \$14.63
4 Outlet Turret Body	41504-00 \$19.62	41514-00 \$21.02	41544-00 \$24.07	41534-00 \$14.63
5 Outlet Turret Body	41505-00 \$19.62	41515-00 \$21.02	41545-00 \$24.07	41535-00 \$14.63
3+2 Outlet Turret*	41505-32* \$19.62	41515-32* \$21.02	41545-32* \$24.07	41535-32* \$14.63



'3+2' CRII TURRETS EXPLAINED

Sq. Lug Outlet (e.g. TeeJet, Hypro) Combo-Jet® Outlets

41535-32 3+2 Turret 3 Radiallock Outlets 2 Sq. Lug Outlets

Only CRII turrets allow for outlet arms to be changed, replaced or plugged.

Combo-Rate® Side Take-Off Turrets

Multi-Outlet Turrets with reversible left/right module stems, mounted on the side of the turret body.

Model	Part # & MSRP			
	Dia. Check Valve	Manual ON/OFF	Air-Off Operated	PWM (w/o nut)**
3 Outlet Side Turret	41603-00 \$22.02	41613-00 \$23.42	41643-00 \$26.46	41633-00 \$17.03
4 Outlet Side Turret	41604-00 \$22.02	41614-00 \$23.42	41644-00 \$26.46	41634-00 \$17.03
5 Outlet Side Turret	41605-00 \$22.02	41615-00 \$23.42	41645-00 \$26.46	41635-00 \$17.03
3+2 Outlet Side Turret*	41605-32 \$22.02	41615-32 \$23.42	41645-32 \$26.46	41635-32 \$17.03

UNIVERSAL SIDE TURRETS

Switch a module stem from left to right in seconds. No extra parts.

180° Reversible Module Stems

41635-00 PWM Side Turret** (w/o nut)

Right Module Orientation Left Module Orientation

41615-00 Manual ON/OFF Module

41615-00 Manual ON/OFF Side Turret w/ Spray tips

* '-32' turrets have 3 Combo-Jet® nozzle outlets & 2 square-lug nozzle outlets.
** PWM bodies/turrets do not include a body nut or control module.

Combo-Rate® Turret & Body Replacement Parts & Repair Kits

41502-11	TURRET BODY REPAIR KIT (2 BODIES) - FKM	\$15.69
41502-12	TURRET BODY REPAIR KIT (2 BODIES) - VITON®	\$47.21
41502-04	TURRET OUTLET, COMBO-JET®	\$0.98
41502-10	TURRET OUTLET ARM, SQUARE LUG	\$0.98
41502-05	TURRET OUTLET PLUG	\$0.76
20455-07	TURRET OUTLET O-RING, #110 Duro 70, FKM	\$0.27
40200-02	INTER-BODY O-RING, #206 Duro 70, FKM	\$0.25
41331-03	CRII NOZZLE BODY SCREW (FOR BODIES MFG'D AFTER 2016)	\$0.36
41100-15	O-RING REPAIR KIT (6 BODIES) - FKM	\$9.79
41100-16	O-RING REPAIR KIT (6 BODIES) - VITON®	\$47.99

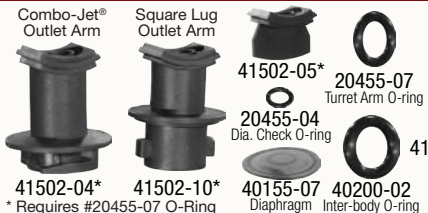

COMBO-RATE® Turret Repair Kits (For up to 2 turrets):	10x Turret Outlet O-rings	Buna Kit includes #20455-07	VITON™ Kit incl. #40155-13
	4x Turret Core O-rings	#41502-06	#41502-V6
	2x Diaphragm	#40155-07	#40155-12
	2x Combo-Jet Outlet Arm	#41502-04	#41502-04
	2x Turret Plugs	#41502-05	#41502-05
	2x Turret Lock Clips	#41502-09	#41502-09

Combo-Rate® O-Ring Seal Control Manifolds, Regulating Components & Accessories

For premium VITON™ O-ring options, contact Wilger. CANADA 1 (833) 242-4121 USA 1 (877) 968-7695

Combo-Rate® manifolds can be used for a broad range of applications.

Compatible Radiallock caps shown on Page 6.

41130-00	CR THRU BODY, PRESSURE REGULATING VALVE	\$19.94
41131-00	CR END BODY, PRESSURE REGULATING VALVE	\$18.66
41110-00	CR THRU BODY, MANUAL ON/OFF	\$11.18
41111-00	CR END BODY, MANUAL ON/OFF	\$10.38
41252-00	CR FEMALE x 1/4" NPT-M	\$2.65
41253-00	CR FEMALE x 3/8" NPT-M	\$2.65
41255-00	CR FEMALE x 1/4" NPT-F w 3/4" SQ MOUNT	\$3.87
41256-00	CR FEMALE x 3/8" NPT-F w 3/4" SQ MOUNT	\$3.87
41275-00	CR MALE x 1/4" NPT-F	\$2.22
41276-00	CR MALE x 3/8" NPT-F	\$2.22
41251-00	CR END BODY x 1/4" NPT-F PORT	\$4.62

Example Combo-Rate® Manifold pricing: (pressure gauge not incl.)

2 Manual Shut-off control thru bodies with inlet, PRV, and hose barb cap \$57.33

3 Manual Shut-off control thru bodies with inlet, PRV, and hose barb cap \$68.52

Example ORS Manifold pricing: (pressure gauge not incl.)

2 Manual Shut-off control bodies with hose barb outlets, 1/4" NPT-F end cap, and Pressure Regulating Valve (PRV) \$75.88

3 Manual Shut-off control bodies with hose barb outlets, 1/4" NPT-F end cap, and Pressure Regulating Valve (PRV) \$93.15

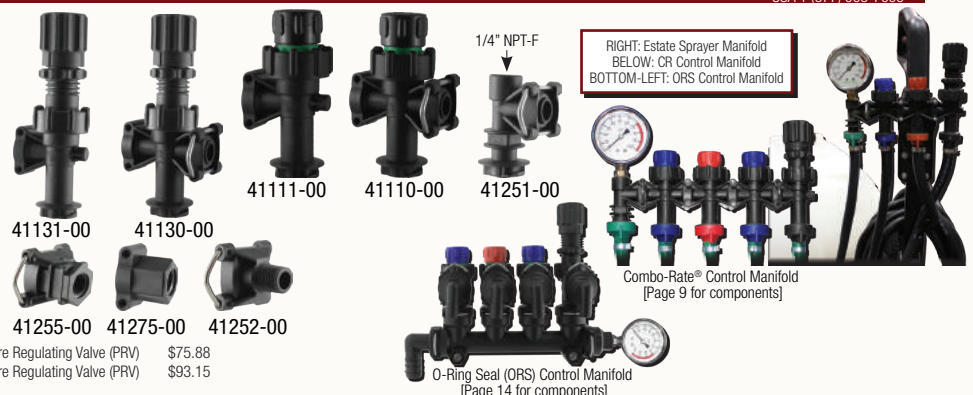

Dry Boom Nozzle Bodies & Clamps

Low Mount Compact Bodies - 11/16" Thread Mount & 5/8" Square-Mount Nozzle Bodies

For premium VITON™ O-ring options, contact Wilger. CANADA 1 (833) 242-4121
USA 1 (877) 968-7695

5/8" Square Mount Body w/ Diaphragm Check Valve (Non-Stocked Item - Contact Factory for Availability)

Type	3/8" Hose Shank	1/2" Hose Shank	3/4" Hose Shank	MSRP
One-Way Left	40380-00	40385-00	40390-00	\$8.70
One-Way Right	40381-00	40386-00	40391-00	\$8.70
Two-Way	40382-00	40387-00	40392-00	\$8.70
Three-Way	40383-00	40388-00	N/A	\$8.70

11/16" Thread Mount Body w/ Diaphragm Check Valve (Non-Stocked Item - Contact Factory for Availability)

Type	3/8" Hose Shank	1/2" Hose Shank	3/4" Hose Shank	MSRP
One-Way Left	40360-00	40365-00	40370-00	\$8.70
One-Way Right	40361-00	40366-00	40371-00	\$8.70
Two-Way	40362-00	40367-00	40372-00	\$8.70

40155-21 REPLACEMENT MODULE RETAINER.....\$1.72
40199-00 LOCK NUT - 11/16" THREAD.....\$0.63



Combo-Jet® Dry Boom Nozzle Bodies

For premium VITON™ O-ring options, contact Wilger. CANADA 1 (833) 242-4121
USA 1 (877) 968-7695

Outlet	Single	Double Swivel	Triple Swivel
Combo-Jet	40352-00	40353-00	40354-00
Square Lug	-	40152-00	40153-00
	\$9.59	\$17.83	\$22.42

Hose Shank Adapters for 3/8" NPT-F Inlet Nozzle Bodies

Model	3/8" Hose Shank	1/2" Hose Shank	3/4" Hose Shank	MSRP
One-Way	40301-00	40306-00	40311-00	\$2.11
Two-Way	40302-00	40307-00	40312-00	\$2.11
Three-Way	N/A	N/A	40313-00	\$2.85



High Mount Dry Boom Nozzle Bodies w/ Hose Shank - 5/8" Square-Mount & Flange Mount Style

For premium VITON™ O-ring options, contact Wilger. CANADA 1 (833) 242-4121
USA 1 (877) 968-7695

5/8" Square Mount Bodies w/ Diaphragm Check Valves (N/S)

Model	3/8" Hose	1/2" Hose	MSRP
One-Way	40450-00	40452-00	\$6.46
Two-Way	40451-00	40453-00	\$6.46
One-Way w/ 1/4" NPT-M	N/A	40454-00	\$6.46

Flange Mount Bodies w/ Diaphragm Check Valves (N/S)

Model	3/8" Hose	1/2" Hose	MSRP
One-Way	40460-00	40462-00	\$8.36
Two-Way	40461-00	40463-00	\$8.36
One-Way w/ 1/4" NPT-M	N/A	40464-00	\$8.36

Square Mount Body w/o Diaphragm Check Valve

40406-00 COMPACT BODY,SQ. MT.,1/2" ONE WAY.....\$2.29
40407-00 COMPACT BODY,SQ. MT.,1/2" TWO WAY.....\$2.29

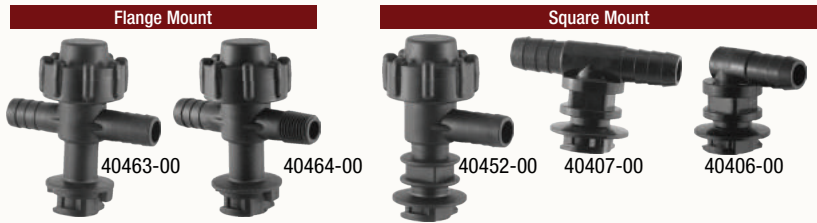

Adjustable Swivel Bodies

For premium VITON™ O-ring options, contact Wilger. CANADA 1 (833) 242-4121
USA 1 (877) 968-7695

Inlet	Outlet					
	Without Dia.		Dia. Check		Manual ON/OFF	
	Single	Double	Single	Double	Single	Double
1/4" NPT-M	40225-00	40226-00	40231-00	40232-00	40237-00	40238-00
	\$7.47	\$8.91	\$11.71	\$13.39	\$13.57	\$21.16
1/4" NPT-F	40227-00	40228-00	40233-00	40234-00	40239-00	40240-00
	\$7.97	\$9.40	\$12.22	\$17.90	\$14.12	\$21.68
1/4" NPT-M x 1/4" NPT-F	40229-00	40230-00	40235-00	40236-00	40241-00	40242-00
	\$8.36	\$9.81	\$12.61	\$18.29	\$14.51	\$22.06
3/8" Hose Shank w/ Sq. Mount	40243-00	-	40244-00	-	40245-00	-
	\$7.47	-	\$11.71	-	\$13.58	-

40237-03 SHUT-OFF DIAPHRAGM MODULE ASSEMBLY.....\$5.36



Clamps for Sprayer Booms & 1/4" Bolt Mount Equipment

Contact factory for clamp availability and leadtimes. CANADA 1 (833) 242-4121
USA 1 (877) 968-7695

Boom Clamps for 5/8" Square-Mount Nozzle Bodies (Stainless Steel)

Size	5/8" Square Mount Clamp (SS)			High Reach 5/8" Sq. Mt Clamp (SS)		
	Pipe	Sq. Tube	MSRP	Pipe	Sq. Tube	MSRP
1/2"	40320-SS	N/A	\$13.97	N/A		-
3/4"	40321-SS	40325-SS	\$13.97	3/4" to 1-1/4"	40341-SS	\$22.49
1"	40322-SS	40326-SS	\$13.97			
1 1/4"	N/A	40327-SS	\$13.97	1-1/2" to 2"	40342-SS	\$22.49
1 1/2"	N/A	40328-SS	\$13.97			
2"	N/A	40330-SS	\$13.97			

40343-SS SQ MT EXTRA HIGH REACH DRY BOOM CLAMP, 3/4" TUBE.....\$28.73

Clamps for 1/4" Bolt-Mount Bodies & Manifolds (Stainless Steel)

Size	Two-Hole Bolt-Mount Clamps (fits 1/4" to 5/16" bolts)		Three-Hole Bolt-Mount Clamps (fits 1/4" to 5/16" bolts)	
	Sq Tube	MSRP	Sq. Tube	MSRP
1"	40550-SS	\$20.17	40553-SS	\$20.17
1 1/4"	40551-SS	\$20.17	40554-SS	\$20.17
1 1/2"	40552-SS	\$20.17	40555-SS	\$20.17

Clamps for 3/4" Square-Mount Adapters to CR11 Nozzle Bodies

Size	3/4" Square Mount Nozzle Body Clamp	MSRP
1" Sq. Tube	41261-SS	\$13.97
1 1/4" Sq. Tube	41262-SS	\$13.97
1 1/2" Sq. Tube	41263-SS	\$13.97
2" Sq. Tube	41264-SS	\$13.97

Example of 3/4" Square mount clamp and adapter, mating to a Common-Rate stacking U-clip
41261-SS
Use #41255-00 (1/4" NPT-F) or #41256-00 (3/8" NPT-F) Adapters

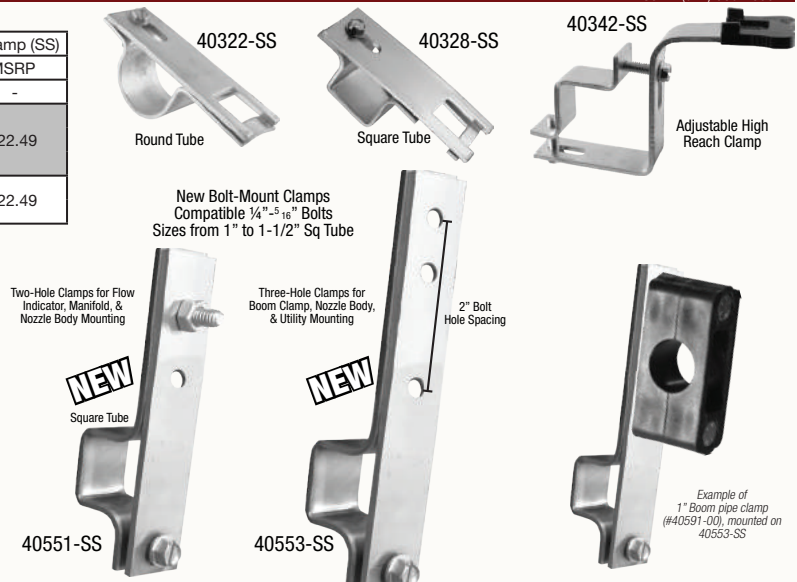

1" QUICK-NUT Stainless Steel Fluid Supply System

Less Cost. Less Weight. Easier to Service.

For the Full Quick-Nut SST Brochure, visit www.wilger.net

Lighter Booms
weighs 23% of sch 40 pipe
66% of aluminum
Lighter than hose

Less Pressure Drop
with inside diameter >1.25"

Sweep Fittings
reduce turbulence &
increase flow capacity

Lower Cost
compared to other
pipe plumbed booms

Less Chemical Residue Build-Up
compared to hose plumbed boom

Recirculating Boom
compatible boom fittings and
tubing

1" Quick-Nut Stainless Steel Tubing & Fittings

Contact Wilger For Custom Boom Tube Pricing and Hole Configurations
CANADA USA
1 (833) 242-4121 1 (877) 968-7695
info@wilger.net WilgerESC@WilgerESC.com

Example of a few possible configurations
of 1" Quick Nut SST Fittings

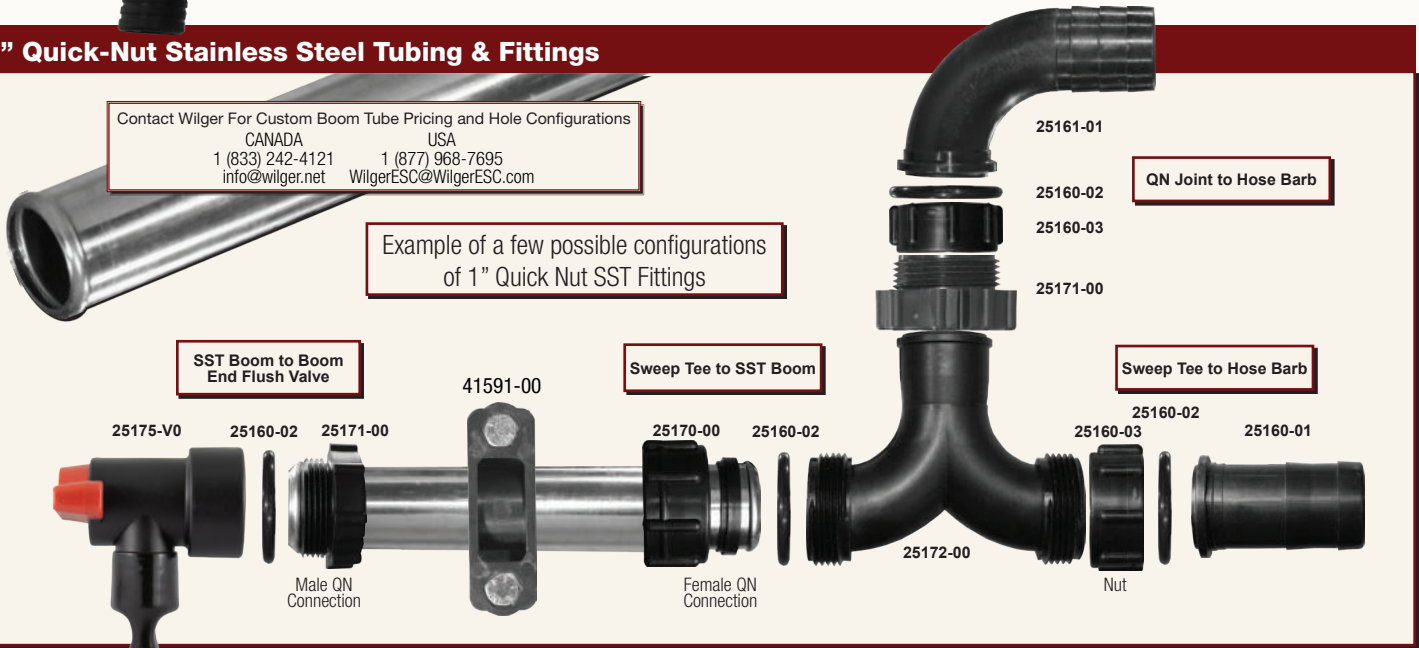

1" Quick-Nut SST Fittings - Use with 1" Quick-Nut Stainless Steel Boom Tube (1.315" O.D. & 1.263" ID.)

1" Hose Shank	
25166-01	QN HOSE SHANK - 1" SST x 1" STRAIGHT SHANK.....\$3.60
25167-01	QN HOSE SHANK - 1" SST x 1" SWEEP 90 DEGREE.....\$4.87
25168-00	QN SWEEP TEE - 1" HOSE SHANK x 1" SST x 1" SST.....\$9.05
1-1/4" Hose Shank	
25160-01	QN HOSE SHANK - 1" SST x 1 1/4" STRAIGHT SHANK.....\$3.60
25161-01	QN HOSE SHANK - 1" SST x 1 1/4" SWEEP 90 DEGREE.....\$4.87
25162-01	QN HOSE SHANK - 1" SST x 1 1/4" SWEEP 45 DEGREE.....\$4.88
25169-00	QN SWEEP TEE - 1 1/4" HOSE SHANK x 1" SST x 1" SST.....\$9.05

1" QN SST Sweep Tee	
25172-00	QN SWEEP TEE - 1 1/4" JOINT ADAPTER x 1" SST x 1" SST.....\$9.05

1" QN SST Tube End Adapters (1.315" O.D.)	
25170-00	QN FEMALE BOOM END ADAPTER ASSY - 1.315" TUBE x 1" SST \$4.37
25171-00	QN MALE BOOM END ADAPTER - 1.315" TUBE x 1" SST.....\$2.33

1" QN SST Nut, End Caps & O-Rings	
25160-03	QN 1" SST - NUT.....\$2.50
25163-01	QN 1" SST - PLUG.....\$1.99
25164-01	QN 1" SST x 3/4" NPT FE ADAPTER.....\$5.04
25165-01	QN 1" SST SIGHT BULB PLUG, CLEAR.....\$2.15
25160-02	O-RING, FRM #219 (For 1" QN SST Fittings).....\$0.67
25160-V2	O-RING, VITON® #219 (For 1" QN SST Fittings).....\$2.15

Boom Mount Clamps - Two (2) clamp halves are normally required.	
41590-00	BOOM MOUNT CLAMP - for 1.25" O.D. TUBE.....\$2.38
41591-00	BOOM MOUNT CLAMP - for 1.315" O.D. TUBE & 1" Sch40 PIPE.....\$2.38

Boom End Flush Valves (BEFV) & BEFV Components	
25175-V0	QN SST BOOM-END FLUSH VALVE [1-1/4" NPT COMPATIBLE]...\$26.87
25176-V0	QN BOOM-END FLUSH VALVE - 1" NPT FEMALE.....\$31.88
25137-00	ADAPTER - QN SST BEFV TO 1" NPTF.....\$3.12
25137-00	ADAPTER KIT - QN BEFV TO 1" NPTF ADAPTER W/ O-RING.....\$5.28
25175-10	BOOM END FLUSH VALVE DUST CAP.....\$1.60
25175-11	BEFV O-RING REPAIR KIT (2 VALVES).....\$12.03
25175-03	BEFV HANDLE, SHORT.....\$2.92
25175-13	BEFV HANDLE, LONG, 1-1/4".....\$2.85

BEFV & Fittings for Case Thin Wall Steel (TWS) Booms	
41400-01	TWS MALE END L/R THREAD KIT, ORDER WITH 41400-02.....\$4.54
41400-02	TWS MALE END BINDING RING, ORDER WITH 41400-01.....\$2.46
41400-03	TWS FEMALE NUT - 1.315" TUBE.....\$2.54
41400-04	TWS MALE END LEFT THREAD.....\$2.35
41400-05	TWS MALE END RIGHT THREAD.....\$2.35
41401-01	ADAPTER COUPLER BODY - TWS x 1 1/4" NPTF.....\$5.57
41402-V0	TWS BOOM-END FLUSH VALVE - 1.315" OD PIPE.....\$26.87
41403-00	ADAPTER - TWS BEFV TO 1" NPTF.....\$3.12
41403-V0	TWS BEFV TO 1" NPTF ADAPTER W/ VITON® O-RING.....\$5.28

Hose Shank & Threaded Tee Fittings

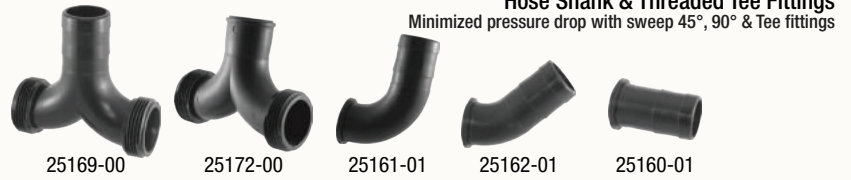

Quick-Nut SST Connections & Components

Easy assembly and disassembly without tools
1" QN SST thread is compatible with 1-1/4" NPT

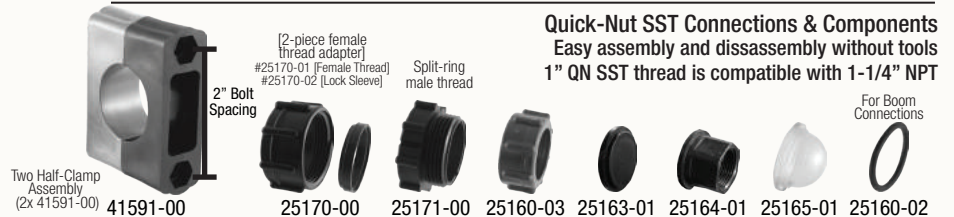

NEW FLUSH VALVE HANDLE

Longer [2-3/4"] handle available.
Retrofits onto existing flush valves.
Better leverage and turning.

Short handles are still available for applications that may experience brush contact that could open valve.



CASE Thin Wall Steel (TWS) Boom End Flush Valve & Adapters

Compact flush valve for flushing boom sections
Fits CASE TWS thread or 1" NPT thread with adapter



1/2" QUICK-NUT Stainless Steel Fluid Supply System

Even Less Cost. Even Less Weight. Still Easy to Service, Just Smaller.

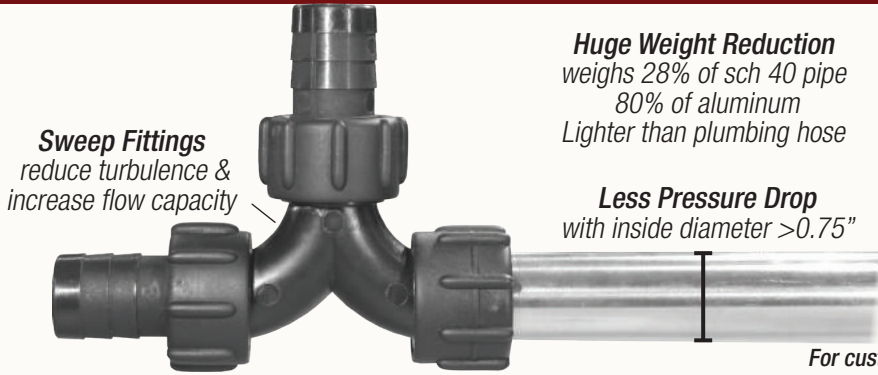

Sweep Fittings
reduce turbulence &
increase flow capacity

Huge Weight Reduction
weighs 28% of sch 40 pipe
80% of aluminum
Lighter than plumbing hose

Less Pressure Drop
with inside diameter >0.75"

Lower Cost
compared to other
pipe plumbed booms

**Less Chemical
Residue Build-Up**
compared to hose plumbed boom

Easy Maintenance & Repair
without requiring tools
or thread sealant

For custom boom section lengths or spacing, call or e-mail Wilger.

1/2" Quick-Nut Stainless Steel Tubing & Fittings

Contact Wilger For Custom Boom Tube Pricing and Hole Configurations
CANADA USA
1 (833) 242-4121 1 (877) 968-7695
info@wilger.net WilgerESC@WilgerESC.com

Example of a few possible configurations
of 1/2" Quick Nut SST Fittings

No wrenches or other tools required for any maintenance or installation.



1/2" Quick-Nut SST Fittings & Components - Use with 1/2" Quick-Nut Stainless Steel Tubing (0.840" O.D. & 0.788" I.D.)

1/2" Hose Shank	
25120-01	QN HOSE SHANK - 1/2" SST x 1/2" STRAIGHT.....\$3.24
25122-01	QN HOSE SHANK - 1/2" SST x 1/2" SWEEP 90 DEGREE.....\$4.38
25124-01	QN HOSE SHANK - 1/2" SST x 1/2" SWEEP 45 DEGREE.....\$4.38
3/4" Hose Shank	
25121-01	QN HOSE SHANK - 1/2" SST x 3/4" STRAIGHT SHANK.....\$3.24
25123-01	QN HOSE SHANK - 1/2" SST x 3/4" SWEEP 90 DEGREE.....\$4.38
25125-01	QN HOSE SHANK - 1/2" SST x 3/4" SWEEP 45 DEGREE.....\$4.38
1/2" QN SST Sweep Tee	
25128-00	QN SWEEP TEE - 1/2" SST x 1/2" SST x 1/2" SST.....\$8.15
1/2" QN SST O-rings, Nut & End Caps	
25120-02	O-RING, FKM #116 (for 1/2" QN SST Fittings).....\$0.54
25120-V2	O-RING, VITON® #116 (for 1/2" QN SST Fittings).....\$2.35
25120-03	QN 1/2" SST - NUT.....\$2.25
25131-01	QN PLUG - 1/2" SST x PLUG CAP.....\$1.79
25127-01	QN 1/2" SST x 1/4" NPTF ADAPTER.....\$4.53
1/2" Boom Clamp - Two (2) clamp halves are normally required.	
41580-00	BOOM MOUNT CLAMP - for .840" O.D. TUBE.....\$2.14
1/2" QN SST Tube End Adapters (0.840" O.D.)	
25129-00	QN FEMALE BOOM END ADAPTER - 0.840" TUBE x 1/2" SST FE \$3.94
25130-00	QN MALE BOOM END ADAPTER - 0.840" TUBE x 1/2" SST.....\$2.10

Hose Shank & Threaded Tee Fittings Minimized pressure drop with sweep 45°, 90° & Tee fittings



Quick-Nut SST Connections & Components Easy assembly and disassembly without tools 1/2" QN SST thread is compatible with 3/4" NPT

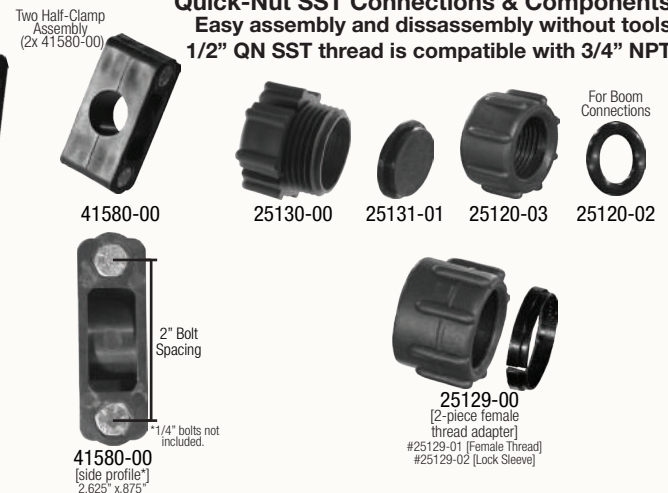

Stainless 1/4" Bolt-Mount Boom Clamps (1" & 1/2" QN SST)

(Compatible with #41580-00, #41590-00, #41591-00 Boom Clamps)

40553-SS	Three Hole 1/4" Bolt-Mount Clamp for 1" Square Tube.....\$20.17
40554-SS	Three Hole 1/4" Bolt-Mount Clamp for 1-1/4" Square Tube.....\$20.17
40555-SS	Three Hole 1/4" Bolt-Mount Clamp for 1-1/2" Square Tube.....\$20.17



Wilger Visual Ball Flow Indicators

See Any Application Accurately, Even When You Can't See Your Outlets.

For the Full Flow Indicator Brochure, visit www.wilger.net

Required Flow Indicator Column Storage

T Wilger Flow Indicator columns are made from a specialty UV stabilized compound (TPX™) that maximizes chemical resistance, allowing it to be used for a wide range of chemical applications. As with any plastic, UV exposure degrades the flow indicator columns. To maximize flow indicator column clarity, it is required to completely cover the flow indicator columns from UV exposure (sun/etc.) when not in use.

PRO TIP: When assembling any Flow Indicator or O-ring Seal (ORS) components, using a touch of lubricant (e.g. liquid silicone) on O-rings makes assembly and maintenance easy.

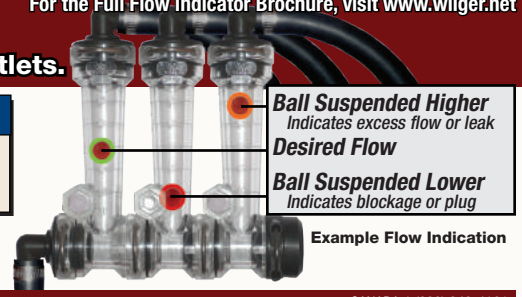

Ball Flow Indicator Columns, Assemblies & Kits

For custom assemblies or kits, contact Wilger. CANADA 1 (833) 242-4121 USA 1 (877) 968-7695

Manifold Feed Ball Flow Indicators

For monitoring many lines from a single feed (i.e. Liquid fertilizer kits for a planter)

Column Model	Kit	Part # & MSRP
Ultra Low Flow	FKM KIT	20475-00 \$27.17
	Body Only	20475-01 \$16.79
Low Flow	FKM KIT	20470-00 \$27.17
	Body Only	20470-01 \$16.79
Standard Flow	FKM KIT	20460-00 \$27.17
	Body Only	20460-01 \$16.79

*MANIFOLD KITS INCLUDE: Flow Indicator Body, Ball Retainer (#20460-02), O-ring seal (#20460-03), 2x U-clips (#20460-04), Green Ball (#20460-08), Red Plastic Ball (#20460-07), Red Glass Ball (#20460-06), 1/2" Stainless Ball (#20460-05)

2019 O-RING UPGRADE: FKM

All Wilger parts are transitioning to being manufactured with FKM o-rings & seals. The fluoroelastomer (FKM) o-ring provides superior chemical resistance and durability over Buna O-rings. Premium Viton® o-rings, seals and assemblies will continue to be available.

EXAMPLE FLOW INDICATOR ASSEMBLY

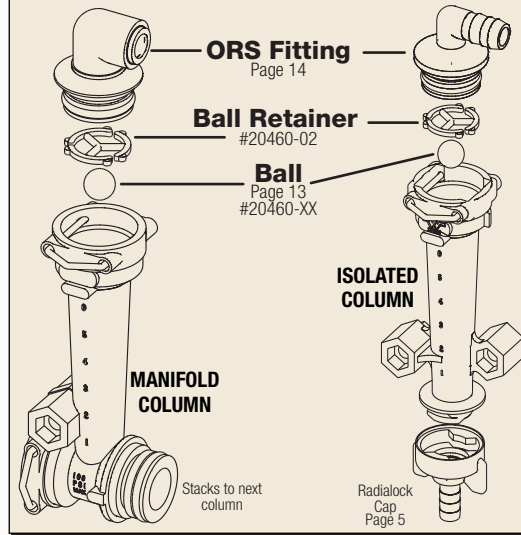

Isolated Feed Ball Flow Indicators

For monitoring individual lines (i.e. Squeeze Pump)

Column Model	Kit	Part # & MSRP
Low Flow 0.05-0.65 us gpm	Isolated Kit	20490-00 \$21.35
	Body Only	20490-01 \$13.43
Standard Flow 0.07-2.7 us gpm	Isolated Kit	20480-00 \$21.35
	Body Only	20480-01 \$13.43

*ISOLATED KITS INCLUDE: Flow Indicator Body, Ball Retainer (#20460-02), U-clip (#20460-04), Green Ball (#20460-08), Red Plastic Ball (#20460-07), Red Glass Ball (#20460-06), 1/2" Stainless Ball (#20460-05)

Flow Indicator Column Specifications*	
Max Operating Pressure:	100 PSI (7 BAR)
Max Metered Flow Rate:	Up to 8.0 US gpm
Max Operating Temperature:	185°F / 85°C
O-Ring Seal Materials:	FKM or Viton®
U-clip Material:	Stainless Steel (302)
ORS Fitting Material:	Glass-Reinforced Polypropylene
Flow Column Material:	TPX™ (Polymethylpentene)

Flow Indicator Components & Balls

For flow indicator ball selection, refer to the chart below, or use the calculators at www.wilger.net.

20460-11	Manifold Feed Components Kit (w/o Indicator Body)	\$10.07
20480-02	Isolated Feed Components Kit (w/o Indicator Body)	\$6.74
20460-02	Ball Retainer	\$0.74
20460-04	U-CLIP, 302SS	\$1.81
20460-03	O-ring - #212 FKM (For ORS Body and Fittings)	\$0.34
20460-15	O-ring - #212 Viton® (For ORS Body and Fittings)	\$2.27
40225-04	O-ring - #015 FKM (For ORS Metering Orifices)	\$0.25
40225-05	O-ring - #015 Viton® (For ORS Metering Orifices)	\$1.89
40550-SS	2 Hole 1/4" Bolt-Mount Clamp for 1" Sq Tube	\$20.17
40551-SS	2 Hole 1/4" Bolt-Mount Clamp for 1-1/4" Sq Tube	\$20.17
40552-SS	2 Hole 1/4" Bolt-Mount Clamp for 1-1/2" Sq Tube	\$20.17

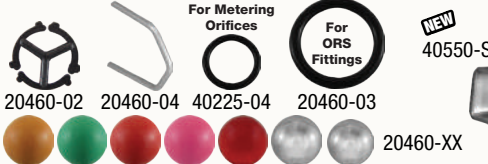

Ball Description & Color	Part #	Flow Indicator Columns & Flow Ranges			MSRP
		Ultra Low Flow	Low Flow	Standard Flow	
Orange Polypropylene Ball	20460-13	0.01-0.04	0.05-0.12	0.07-0.25	\$0.88
Green Polypropylene Ball	20460-08	0.01-0.04	0.05-0.12	0.07-0.25	\$0.88
Red Celcon Ball	20460-07	0.02-0.06	0.06-0.16	0.10-0.35	\$0.88
Pink Celcon Ball	20460-14	0.02-0.06	0.06-0.16	0.10-0.35	\$0.88
Red Glass Ball	20460-06	0.06-0.13	0.12-0.26	0.21-0.72	\$0.88
1/2" Stainless Steel (302) Ball	20460-05	0.13-0.24	0.18-0.65	0.40-1.70	\$1.84
7/16" Stainless Steel (302) Ball	20460-10	n/a	n/a	1.00-2.70	\$1.98

*Density/Viscosity of liquid used can effect operating range. In very dense liquids, balls may float.

PRO TIP: Using two balls simultaneously - Cover changes in flow & speed
If a lighter ball suspends too high, try using the next heavier ball below, to cover changes in application rates or speeds.

O-Ring Seal (ORS) Check Valve Bodies

Model	Dia. Check Valve	Manual ON/OFF	Air-Off Operated	Optional Nut
ORS Male to ORS Female	20550-00	20551-00	20552-00	20553-00
	\$9.85	\$11.32	\$18.72	\$5.88
ORS Male to COMBO-JET® Cap	20560-00	20561-00	20562-00	20563-00
	\$8.03	\$9.51	\$16.90	\$4.07



O-Ring Seal (ORS) Hose Barb, Push-in Tube & Threaded Fittings

All ORS Components fit into Wilger Ball Flow Indicator Columns & Fittings

ORS Hose Barb Fittings

Straight ORS Hose Barbs		
1/4"	20500-00	\$3.45
3/8"	20501-00	\$3.45
1/2"	20502-00	\$3.45
3/4"	20503-00	\$3.45
1"	20504-00	\$3.80

90° ORS Hose Barb		
3/8"	20511-00	\$3.45
1/2"	20512-00	\$3.45
5/8"	20514-00	\$3.45
3/4"	20513-00	\$3.45

Push-In Tube Revisions

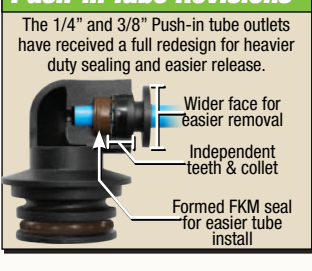

Push In Tube & Threaded Fittings

90° Push-In Tube ORS Outlets		
1/4"	20516-00	\$6.07
5/16"	20528-00	\$6.75
3/8"	20517-00	\$6.75

Straight Push-In Tube Outlets		
1/4"	20506-00	\$6.07
5/16"	20508-00	\$6.75
3/8"	20507-00	\$6.75

ORS Threaded Outlets		
90° 1/4" NPT-F	20518-00	\$3.45
1/4" NPT-F	20519-00	\$3.45

PRO TIP: Lubricate when assembling ORS fittings
When assembling any flow indicator or O-ring seal (ORS) components, using a touch of lubricant (e.g. liquid silicone) on the O-ring makes assembly and maintenance easy.

O-Ring Seal (ORS) Fittings & Components

Designed for Powerful Liquid Handling Solutions

For the Full Flow Indicator Brochure, visit www.wilger.net

NEW O-Ring Seal (ORS) Metering Orifices*

CANADA 1 (833) 242-4121
USA 1 (877) 968-7695

Custom ORS Metering Orifices	Custom Orifice		Blank Orifice	
	FKM	Viton®	FKM	Viton®
ORS Orifice Part #	21XXX-00	21XXX-V0	21000-00	21000-V0
Color	BLACK	BLACK	BLACK	BLACK
MSRP	\$5.67	\$7.44	\$0.87	\$2.02



21500-V01



21XXX-00**

**Custom sized ORS metering orifices are available in sizes from 0.009" to 0.25" hole sizes. Refer to full chart or ORS metering orifice calculator online @ www.wilger.net
If hole size is known, replace XXX in 21XXX-00 with hole size; e.g. 0.018" hole = 21018-00.

*Metering orifices can be inserted into all ORS fittings, utilized to control flows ranging from 0.004 to 8.0 USGPM.

ISO Color-Coded ORS Metering Orifices (rated in us gallons/minute flow rates based on water @ 40PSI) [FKM O-ring is standard]

Flow Rate (US gpm)	0.01	0.07	0.1	0.15	0.2	0.25	0.3	0.4	0.5	0.6	0.8	1.0	1.25	1.5	2.0
ORS Orifice Part #	21500-V005	21500-V007	21500-V01	21500-V015	21500-V02	21500-V025	21500-V03	21500-V04	21500-V05	21500-V06	21500-V08	21500-V10	21500-V125	21500-V15	21500-V20
Color	BLACK	PINK	ORANGE	GREEN	YELLOW	PURPLE	BLUE	RED	BROWN	GREY	WHITE	LT BLUE	TEAL	LT GREEN	TAN
MSRP	\$4.64	\$4.64	\$3.81	\$3.81	\$3.81	\$3.81	\$3.81	\$3.81	\$3.81	\$3.81	\$3.81	\$3.81	\$3.81	\$3.81	\$3.81

Calculating Required Flow Rate

To determine the flow rate (or application rate required), use the following equations:
W = Nozzle or Outlet Spacing (INCH)

$$\text{GPM (per nozzle)} = \frac{\text{GPA} \times \text{mph} \times \text{W}}{5940}$$

$$\text{GPA} = \frac{5940 \times \text{GPM (per outlet)}}{\text{mph} \times \text{W}}$$

EASY-TO-USE ORS orifice and ball selector calculator available @ www.WILGER.NET

Orifice Part#*	Flow Rate (US gallons/minute)					
	5PSI	10PSI	15PSI	20PSI	30PSI	40PSI
21009-XX	0.00	0.01	0.01	0.01	0.01	0.01
21011-XX	0.01	0.01	0.01	0.01	0.01	0.02
21013-XX	0.01	0.01	0.01	0.02	0.02	0.02
21015-XX	0.01	0.01	0.02	0.02	0.03	0.03
21018-XX	0.01	0.02	0.03	0.03	0.04	0.04
21500-V005	0.02	0.03	0.03	0.04	0.04	0.05
21020-XX	0.02	0.03	0.03	0.04	0.05	0.05
21022-XX	0.02	0.03	0.04	0.04	0.05	0.06
21500-V007	0.02	0.03	0.04	0.05	0.06	0.07
21025-XX	0.03	0.04	0.05	0.06	0.07	0.08
21026-XX	0.03	0.04	0.05	0.06	0.07	0.09
21027-XX	0.32	0.46	0.56	0.65	0.79	0.91
21028-XX	0.03	0.05	0.06	0.07	0.09	0.10
21500-V01	0.04	0.05	0.06	0.07	0.09	0.10
21029-XX	0.04	0.05	0.07	0.08	0.09	0.11
21031-XX	0.04	0.06	0.07	0.09	0.11	0.12
21500-V015	0.05	0.07	0.09	0.10	0.13	0.15
21035-XX	0.06	0.08	0.10	0.11	0.14	0.16
21037-XX	0.06	0.09	0.11	0.12	0.15	0.17
21039-XX	0.07	0.10	0.12	0.13	0.17	0.19
21500-V02	0.07	0.10	0.13	0.14	0.18	0.20
21041-XX	0.08	0.11	0.13	0.15	0.19	0.21

Orifice Part#*	Flow Rate (US gallons/minute)					
	5PSI	10PSI	15PSI	20PSI	30PSI	40PSI
21043-XX	0.08	0.12	0.14	0.16	0.20	0.23
21500-V025	0.09	0.13	0.16	0.18	0.22	0.25
21046-XX	0.09	0.13	0.16	0.19	0.23	0.27
21047-XX	0.10	0.14	0.17	0.19	0.24	0.27
21049-XX	0.10	0.15	0.18	0.21	0.26	0.29
21500-V03	0.11	0.15	0.18	0.21	0.26	0.30
21051-XX	0.11	0.16	0.20	0.23	0.28	0.32
21052-XX	0.12	0.17	0.21	0.24	0.29	0.33
21055-XX	0.13	0.19	0.23	0.27	0.33	0.38
21500-V04	0.14	0.20	0.24	0.28	0.35	0.40
21060-XX	0.16	0.22	0.27	0.32	0.39	0.45
21061-XX	0.16	0.23	0.29	0.33	0.40	0.47
21063-XX	0.17	0.25	0.30	0.35	0.43	0.49
21500-V05	0.18	0.25	0.31	0.35	0.43	0.50
21064-XX	0.18	0.25	0.31	0.36	0.44	0.51
21065-XX	0.18	0.26	0.32	0.37	0.45	0.52
21067-XX	0.20	0.28	0.34	0.39	0.48	0.56
21500-V06	0.21	0.30	0.37	0.42	0.52	0.60
21070-XX	0.22	0.31	0.37	0.43	0.53	0.61
21073-XX	0.23	0.33	0.40	0.47	0.57	0.66
21075-XX	0.25	0.35	0.42	0.49	0.60	0.69
21078-XX	0.27	0.39	0.47	0.54	0.67	0.77

Orifice Part#*	Flow Rate (us gallons/minute)					
	5PSI	10PSI	15PSI	20PSI	30PSI	40PSI
21500-V08	0.28	0.40	0.49	0.57	0.69	0.80
21081-XX	0.29	0.41	0.50	0.58	0.71	0.82
21083-XX	0.32	0.45	0.55	0.64	0.78	0.90
21086-XX	0.33	0.47	0.57	0.66	0.81	0.94
21089-XX	0.35	0.49	0.60	0.69	0.85	0.98
21500-V10	0.35	0.50	0.61	0.71	0.87	1.00
21091-XX	0.37	0.52	0.64	0.74	0.91	1.05
21093-XX	0.39	0.55	0.67	0.77	0.95	1.09
21096-XX	0.42	0.59	0.72	0.83	1.02	1.18
21500-V125	0.44	0.62	0.76	0.88	1.08	1.25
21102-XX	0.46	0.65	0.80	0.92	1.13	1.30
21104-XX	0.48	0.68	0.83	0.96	1.17	1.35
21107-XX	0.52	0.73	0.90	1.04	1.27	1.47
21500-V15	0.53	0.75	0.92	1.06	1.30	1.50
21110-XX	0.55	0.77	0.95	1.09	1.34	1.55
21113-XX	0.58	0.82	1.01	1.16	1.42	1.64
21116-XX	0.61	0.86	1.05	1.22	1.49	1.72
21120-XX	0.63	0.89	1.09	1.26	1.54	1.78
21125-XX	0.69	0.98	1.20	1.39	1.70	1.96
21500-V20	0.71	1.00	1.22	1.41	1.73	2.00
21128-XX	0.72	1.02	1.25	1.45	1.77	2.04
21130-XX	0.75	1.06	1.30	1.50	1.84	2.12

Orifice Part#*	Flow Rate (US gallons/minute)					
	5PSI	10PSI	15PSI	20PSI	30PSI	40PSI
21136-XX	0.84	1.19	1.46	1.68	2.06	2.38
21140-XX	0.89	1.26	1.55	1.79	2.19	2.53
21144-XX	0.93	1.31	1.61	1.85	2.27	2.62
21147-XX	0.95	1.35	1.65	1.90	2.33	2.69
21150-XX	1.02	1.44	1.77	2.04	2.50	2.89
21152-XX	1.05	1.49	1.82	2.10	2.58	2.98
21156-XX	1.10	1.55	1.90	2.20	2.69	3.11
21161-XX	1.16	1.63	2.00	2.31	2.83	3.27
21166-XX	1.21	1.71	2.10	2.42	2.97	3.43
21172-XX	1.33	1.88	2.30	2.66	3.26	3.76
21177-XX	1.41	2.00	2.45	2.83	3.46	4.00
21182-XX	1.47	2.08	2.55	2.95	3.61	4.17
21187-XX	1.56	2.21	2.70	3.12	3.82	4.41
21196-XX	1.73	2.45	3.00	3.46	4.24	4.90
21205-XX	1.87	2.65	3.25	3.75	4.59	5.30
21213-XX	2.02	2.85	3.49	4.03	4.94	5.70
21218-XX	2.11	2.98	3.65	4.21	5.16	5.96
21234-XX	2.45	3.47	4.25	4.91	6.01	6.94
21250-XX	2.83	4.00	4.90	5.66	6.93	8.00

O-Ring Seal (ORS) End Cap & Tee Components

CANADA 1 (833) 242-4121
USA 1 (877) 968-7695

ORS Tees and Other Plumbing Fittings

Model	Part #	MSRP
90° ORS Elbow [M x F]	20520-00	\$7.31
ORS Tee [M x M x F]	20522-00	\$9.21
ORS Tee w/ 1/4" NPT-F [M x M x F w/ 1/4" NPT]	20526-00	\$9.21
3/8" x Blind ORS Tee [Blind F x M x 3/8" NPT]	20523-00	\$7.70
3/8" NPT-F x ORS Tee [F x M x 3/8" NPT]	20524-00	\$7.70
2 Outlet ORS-F Splitter [F x F x M]	20527-00	\$9.75
1" NPT-F x ORS Tee [M x M x 1" NPT]	20525-00	\$9.21



20524-00



20523-00



20522-00

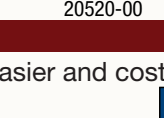

20520-00



20527-00



20525-00



20526-00

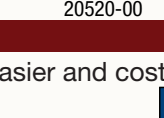

20520-00

PRO TIP: Planning your manifold plumbing

- Depending on size of the manifold bank, plumb with a center-fed tee.
- Limiting the number of consecutive [modular] flow indicators will ensure more accurate ball levels, and more consistent pressure across your equipment.
[e.g. Using 5 flow columns on both sides of a tee would indicate better than a bank of 10 consecutive flow indicators in a row.]
- Using 1 flow column per outlet (opener/spray tip/row) will provide the most accurate depiction of flow.

NEW O-Ring Seal Manifolds

CANADA 1 (833) 242-4121
USA 1 (877) 968-7695

A new Wilger ORS manifold that will make it even easier and cost effective to setup and manage liquid applications.

Model	O-ring	Part #	MSRP
2 Outlet Splitter	FKM	20527-00	\$9.75
	Body Only	20527-01	\$3.91
1 Outlet Manifold	FKM	20571-00	\$9.75
	Body Only	20571-01	\$3.91
2 Outlet Manifold	FKM	20572-00	\$11.90
	Body Only	20572-01	\$4.75
3 Outlet Manifold	FKM	20573-00	\$14.06
	Body Only	20573-01	\$5.59
4 Outlet Manifold	FKM	20574-00	\$16.55
	Body Only	20574-01	\$6.75



20527-00



20571-00

Example ORS Manifold Configurations

20551-00 Check Valve
20511-00 Outlet
20517-00
21500-V01 Metering Orifice
20529-00 Plug
20521-00 Cap
20513-00 Feed Inlet
20574-00



20572-00



20573-00

NEW

Wilger Electronic Flow Monitoring System

A New Row-by-Row Flowmeter & Monitoring System

For the Full Flow Monitoring System Brochure, visit www.wilger.net

NEW WILGER PRODUCT: Electronic Flowmeter (EFM) & Electronic Monitoring System

Introducing a new Wilger product, along with new partnership for a row-by-row flow monitoring system.

The Wilger electronic flowmeter (EFM) is a durable flow meter built for agricultural chemical & liquid applications. It is maintainable, has patent pending stabilizing jets for greater accuracy, and is able to tie into other OEM monitors and application systems.



System at a glance

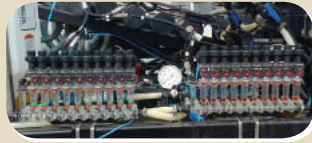

Example configuration for 2 different products being applied on 11 rows. Both products are monitored through the same flow monitoring system.

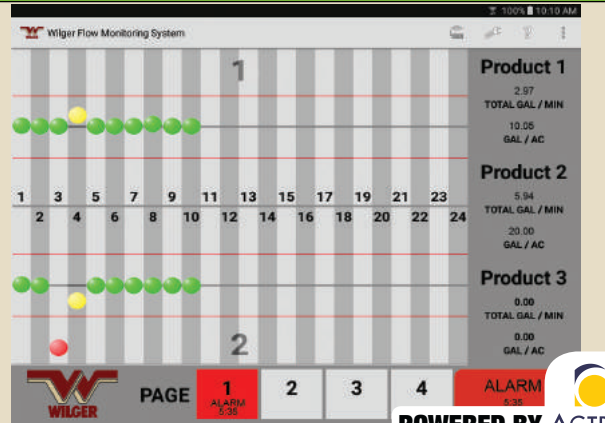

The EFM sensors are now available for an after-market installation system, which uses an android tablet in the cab to monitor the flow of up to 196 outlets, and allowing breakdown and monitoring of up to 3 products.

POWERED BY AGTRON

Electronic Flowmeter Components & Sensors

Electronic Flowmeter (EFM) Body & Components

20580-00	EFM KIT, TPX, ORS, incl. 4 JET (no sensor)	\$43.66
20580-01	EFM BODY ONLY, TPX	\$9.95
20580-02	EFM MODULE, w/ O-RING (no sensor)	\$4.37
20580-08	EFM IMPELLER ASSEMBLY	\$1.98
20580-10	EFM IMPELLER MAGNET	\$0.60
20580-11	EFM IMPELLER AXLE PIN	\$0.65
20580-13	O-RING, #119, VITON (for EFM module)	\$0.56
20581-01	EFM JET, 0.004-0.12 GPM, GREEN	\$1.87
20581-03	EFM JET, 0.10-0.31 GPM, RED	\$1.87
20581-05	EFM JET, 0.18-0.98 GPM, TAN	\$1.87
20581-07	EFM JET, 0.57-1.53 GPM, BLACK	\$1.87
20583-00	EFM CABLE, SINGLE SENSOR, w/o connector	\$20.34
20584-00	EFM CABLE ASSY, SINGLE SENSOR, w/ connector	\$27.12
20585-00	EFM CABLE, QUAD-SENSOR, w/ connector	\$41.80

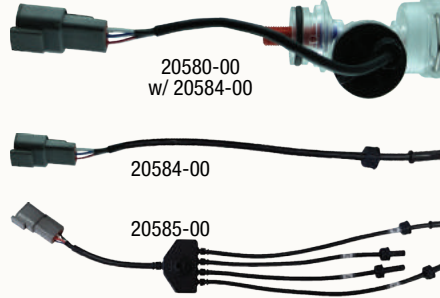

*Jets include snap-in strainers

JET Color*	Part #	FLOW (us gpm)
GREEN	20581-01	0.01-0.04
RED	20581-03	0.02-0.06
TAN	20581-05	0.02-0.06
BLACK	20581-07	0.06-0.13

Retro-Fit Electronic Flow Monitoring System Components

Assembly Kits

20603-00	EFM ECU BASE KIT	\$1,834.20
	incl. ECU, 20' battery harness, harness terminator, ECU antenna	
20620-00	4CH NODE KIT (incl. Node, harness, sensor cables)	\$714.49
20621-00	16CH NODE KIT (incl. Node, harness, sensor cables)	\$1,058.20
20631-00	1 OUTLET EFM MANIFOLD	\$62.78
	EFM manifolds incl. ORS manifold, EFM body, EFM Jets, no sensors	
20632-00	2 OUTLET EFM MANIFOLD	\$118.16
20633-00	3 OUTLET EFM MANIFOLD	\$173.54
20634-00	4 OUTLET EFM MANIFOLD	\$229.24

Kit Components

20603-01	ELECTRONIC FLOW MONITORING SYSTEM ECU	\$1,470.00
20603-02	ECU BATTERY HARNESS, 20FT	\$255.00
20603-03	ECU ANTENNA	\$36.00
20604-00	ECU HARNESS TERMINATOR	\$73.20
20608-00	4 CHANNEL(4CH) NODE & HARNESS ASSY, EFM	\$606.00
20608-01	4CH NODE, EFM	\$354.00
20608-02	4CH NODE HARNESS, EFM	\$252.00
20611-00	16 CHANNEL(16CH) NODE & HARNESS ASSY, EFM	\$891.00
20611-01	16CH NODE, EFM	\$540.00
20611-02	16CH NODE HARNESS, EFM	\$351.00

Auxiliary Components

20609-00	4CH NODE HARNESS COVER CAP, EFM	\$12.87
20612-00	16CH NODE HARNESS COVER CAP, EFM	\$18.54
20605-00	ECU HARNESS TEE SPLITTER	\$120.00
20615-00	EXTENSION HARNESS, 6FT, NODE HARNESS to SENSOR	\$80.00
20616-00	EXTENSION HARNESS, 12FT, NODE to NODE	\$94.00

Tablet & Mount Components

20600-00	ANDROID TABLET	CONTACT WILGER
	Wilger Electronic Flow Monitoring App	FREE
20601-00	TABLET CASE (Universal 8" Tablet)	CONTACT WILGER
20602-00	RAM@ TABLET MOUNT (Universal 8" Tablet)	CONTACT WILGER

20603-00 ECU BASE KIT BREAKDOWN

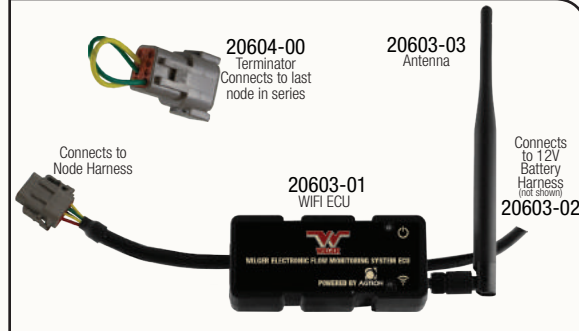

RETROFIT OPTION

The Electronic flow meter is completely retrofittable into a visual flow indicator manifold.

Simply insert the ORS fittings within the plumbing manifold, and you are on your way to have both visual and digital flow indication and monitoring.

More information available at www.WILGER.NET



20620-00 4 CHANNEL (4CH) NODE KIT BREAKDOWN

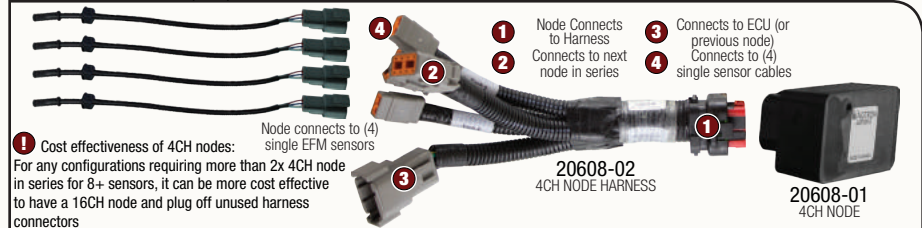

20621-00 16 CHANNEL (16CH) NODE KIT BREAKDOWN

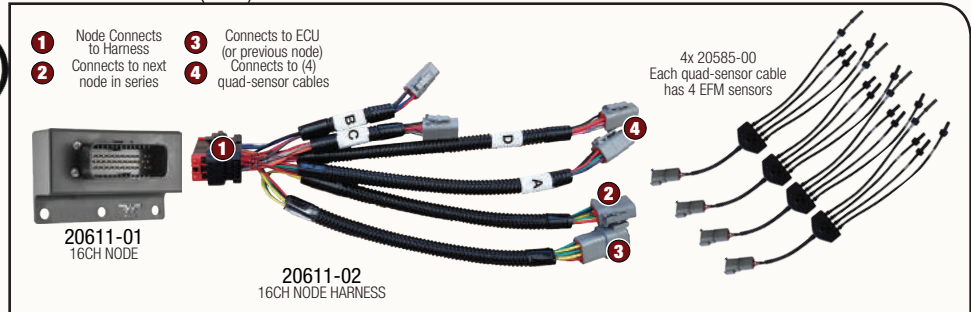

Keyed DEUSTCH® Connectors

As all EFM connectors are keyed deutsch connectors, they cannot be inserted in the wrong orientation, or with the wrong component wires/parts.



FEATURED & NEW PRODUCTS FOR 2019

Wilger Electronic Row-By-Row Flow Monitoring System

Introducing a new Wilger product, along with new partnership for a row-by-row flow monitoring system.

The Wilger electronic flowmeter (EFM) is a durable flow meter built for agricultural chemical & liquid fertilizer applications.

It is maintainable, with patent pending jets for greater accuracy, and is capable of being pulled into OEM monitors and systems.



System at a glance

Example configuration for 2 different products being applied on 11 rows. Both products are monitored through the same flow monitoring system.

The system has been retrofitted onto an existing flow indicator manifold.

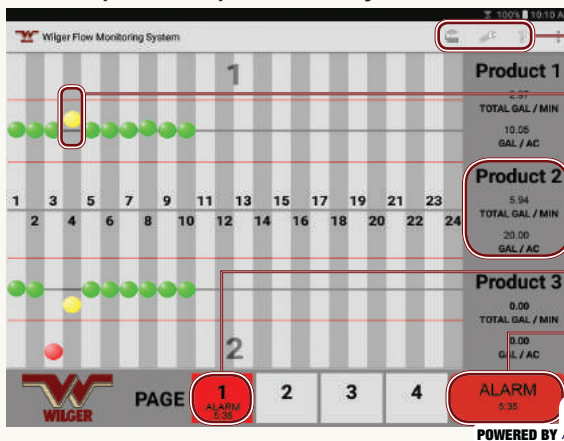

- Simple menu and tools for setting up & customizing applications
- Yellow/red balls & lines show alarm thresholds. Thresholds are customizable to any %.
- Up to 3 different products/rates can be monitored on one EFM system at the same time.
- App cycles through up to 4 pages (up to 48 sensors per page) at custom page cycle speeds.
- Alarm is mutable, and can also sound while app is running in the background.

The EFM sensors are now available for an after-market installation system, which uses an android tablet in the cab to monitor the flow of up to 196 outlets, and allowing breakdown and monitoring of up to 3 products.

COMBO-JET® UR Series

-patent pending-

The new COMBO-JET® UR dual-chamber series spray tips are the next level of drift reduction.

The UR series of spray tips produce an Ultra Coarse spray for applications where drift control is the major consideration.

The UR series of spray tip do not use air induction, and are completely compatible with **all** spray systems, including PWM.

The URs are currently available in -04 to -10 sizes.



COMBO-RATE® II Side Take-Off Turrets

This innovative new Combo-Rate® turret has been designed to improve flexibility when installed on any Combo-Rate nozzle body.

How to Reverse Combo-Rate® Side Turret Orientation



Available Now

Less weight leveraged off the boom pipe
Reversible design adapts to interference with boom frame and fittings
Reversible to a LEFT/RIGHT version in seconds
Ideal for PWM sprayers and tight boom layouts.

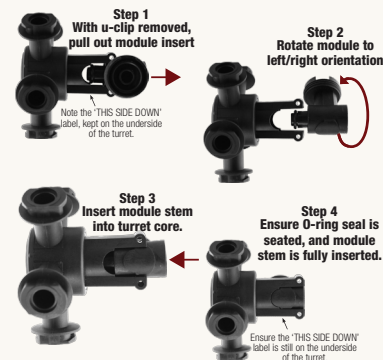

ORS Color Coded Metering Orifices



Precision molded ORS metering orifices are easy to handle, take out and switch.

Color Coded for easy rate checking in the field.
Custom hole-sized ORS orifices still available.

Wilger Product Literature & Tools



Wilger provides free printed product literature, prices lists and tools. Request a copy today.
All brochures are also available at www.wilger.net

Have Questions? We can help!

wilger.net



You can ask Wilger questions directly by phone/email, by website email, Twitter, or CombineForums. Wilger is here to help answer any questions relating to applications with any of Wilger products.

Best of all, it's FREE.



Tip Wizard Updates

Tip Wizard has a new fertilizer streamer tip search, 'favorite' tip option, as well as an improved interface.
Tip Wizard continues to lead the industry as the best spray tip calculator for broadcast applications.

WHERE TO BUY WILGER PRODUCT

To find a list of local dealers/retailers and distributors in your area, visit the WILGER.net 'WHERE TO BUY' page, to easily enter your address to find local Wilger product.

CANADA
Wilger Industries Ltd.
Site 412, Box 280, RR#4
Capital Circle W & Auction Mart Rd.
Saskatoon, SK, Canada S7K 3J7
Phone: 1 (833) 242-4121
Fax: (306) 242-4122
Email: info@wilger.net

UNITED STATES
Wilger Inc.
255 Seahorse Drive
Lexington, TN, USA
38351-6538
Phone: 1 (877) 968-7695
Fax: (877) 968-7613
Email: WilgerEsc@WilgerEsc.com

ARGENTINA
Wilger Argentina
Mitre 697
San Nicolas (2900)
Buenos Aires, Argentina
Phone: +54 9 336 4596710
Email: cjporras@gmail.com

**Focused on Spraying
Performance for
Over 40 Years**

www.wilger.net

Publication #10216-CA
Printed in Canada